

HIGH STRENGTH OPEN END • SELF PLUGGING BLIND RIVET

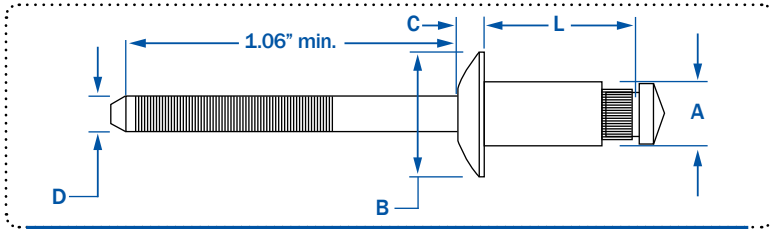

AVAILABLE IN STEEL*, STAINLESS STEEL AND ALUMINUM
 *Steel Parts are plated with clear trivalent zinc
 Per IFI-119

The RKQ® offers is self plugging and offers an interference fit between the knurled mandrel, the rivet body and the hole diameter of the work piece. Its self plugging properties insure that the mandrel is locked within the shear plane which results in superior shear and tensile strength. The RKQ® has a grooved, rattle resistant mandrel which breaks flush with the head in the ideal grip range.



MATERIAL	HEAD STYLE	PART NUMBER	RIVET SIZE	A		L		B		C		D	
				GRIP RANGE	LENGTH	HEAD DIA	HEAD HEIGHT	MANDREL DIA	HOLE SIZE	SHEAR	TENSILE		
				MIN - MAX	MAX	NOM.	NOM.	NOM.	NOM.	MIN. - MAX.	LBS.F	LBS.F	
STEEL	DOME	SBQ - 42	1/8"	.063 - .125	.275	.250	.040	.074	.129 - .133 (#30)	450	350		
		SBQ - 43		.094 - .187	.337								
		SBQ - 44		.126 - .250	.400								
		SBQ - 52	5/32"	.062 - .125	.300	.312	.050	.095	.160 - .164 (#20)	525	500		
		SBQ - 54		.126 - .250	.425								
		SBQ - 56		.251 - .375	.550								
		SBQ - 62	3/16"	.062 - .125	.325	.375	.060	.059	.192 - .196 (#11)	900	700		
		SBQ - 64		.126 - .250	.450								
		SBQ - 66		.251 - .375	.575								
SBQ - 68	.376 - .500	.700											
STAINLESS STEEL	DOME	FBQ - 42	1/8"	.063 - .125	.275	.250	.040	.074	.129 - .133 (#30)	550	530		
		FBQ - 43		.094 - .187	.337								
		FBQ - 44		.126 - .250	.400								
		FBQ - 52	5/32"	.062 - .125	.300	.312	.050	.095	.160 - .164 (#20)	850	820		
		FBQ - 54		.126 - .250	.425								
		FBQ - 56		.251 - .375	.550								
		FBQ - 62	3/16"	.062 - .125	.325	.375	.060	.059	.192 - .196 (#11)	1325	1200		
		FBQ - 64		.126 - .250	.450								
		FBQ - 66		.251 - .375	.575								
FBQ - 68	.376 - .500	.700											
ALUMINUM	DOME	ABQ - 42	1/8"	.063 - .125	.275	.250	.040	.074	.129 - .133 (#30)	220	180		
		ABQ - 43		.094 - .187	.337								
		ABQ - 44		.126 - .250	.400								
		ABQ - 52	5/32"	.062 - .125	.300	.312	.050	.095	.160 - .164 (#20)	340	300		
		ABQ - 54		.126 - .250	.425								
		ABQ - 56		.251 - .375	.550								
		ABQ - 62	3/16"	.062 - .125	.325	.375	.060	.059	.192 - .196 (#11)	480	400		
		ABQ - 64		.126 - .250	.450								
		ABQ - 66		.251 - .375	.575								
ABQ - 68	.376 - .500	.700											