

## HIGH STRENGTH MULTIGRIP™

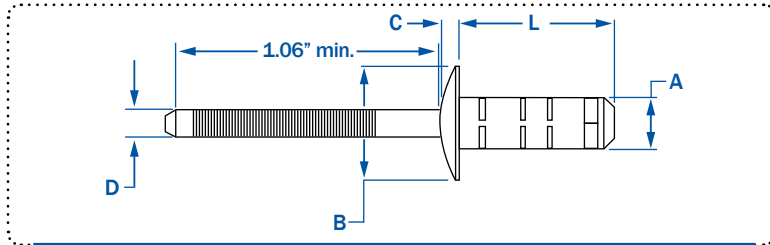

The Rivex® is an advanced MultiGrip™ with increased performance and functionality as compared to standard steel MultiGrip™ rivets. It is also the only MultiGrip™ that is offered in stainless steel. Rivex® rivets consist of a wider grip range and a higher shear and tensile strength. The Rivex® rivet contains an easy entry mandrel head that is grooved and blunt pointed. Its design is rattle resistant and will break flush with the head in the ideal grip range. Its virtual closed end and flush mandrel break makes this rivet leak resistant.

AVAILABLE IN STEEL\* AND STAINLESS STEEL  
 \* Steel Parts are plated with clear trivalent zinc



MATERIAL	HEAD STYLE	PART NUMBER	A	GRIP RANGE	L	B	C	D	HOLE SIZE	SHEAR 1	SHEAR 2	TENSILE
			RIVET SIZE		LENGTH	HEAD DIA	HEAD HEIGHT	MANDREL DIA		MIN. - MAX.	LBS.F	
				MIN. - MAX.	MAX.	MAX.	MAX.	MAX.	MIN. - MAX.	LBS.F	LBS.F	LBS.F
STEEL	DOME	SBS - 0414 - RVX	1/8"	.040 - .276	.560	.300	.044	.087	.129 - .133	293	225	315
		SBS - 0516 - RVX	5/32"	.079 - .315	.620	.330	.060	.110	.161 - .165	518	338	450
		SBS - 0612 - RVX	3/16"	.059 - .200	.480	.398	.063	.118	.193 - .197	945	608	653
		SBS - 0614 - RVX		.059 - .250	.540							
		SBS - 0618 - RVX		.059 - .375	.670							
		SBS - 0622 - RVX	1/4"	.251 - .500	.791	.516	.106	.158	.260 - .272	1508	698	810
SBS - 4844 - RVX	.059 - .201	.480										
STEEL	LARGE FLANGE	SBS - 0614LF - RVX	3/16"	.059 - .250	.540	.638	.083	.118	.193 - .197	945	608	653
		SBS - 0618LF - RVX		.059 - .375	.670							
		SBS - 0622LF - RVX		.251 - .500	.791							
STEEL	C'SUNK	SCS - 0614 - RVX	3/16"	.059 - .250	.540	.346	.055	.118	.193 - .197	945	608	653
		SCS - 0618 - RVX		.059 - .375	.670							
		SCS - 0622 - RVX		.251 - .500	.792							
STAINLESS STEEL	DOME	FBF - 0612 - RVX	3/16"	.059 - .200	.480	.398	.063	.118	.193 - .197	945	608	653
		FBF - 0614 - RVX		.059 - .250	.540							
		FBF - 0618 - RVX		.059 - .375	.670							
		FBF - 0622 - RVX		.251 - .500	.791							

