

RIVETKING® STANDARD BLIND RIVETS - ALL STEEL - CLOSED END

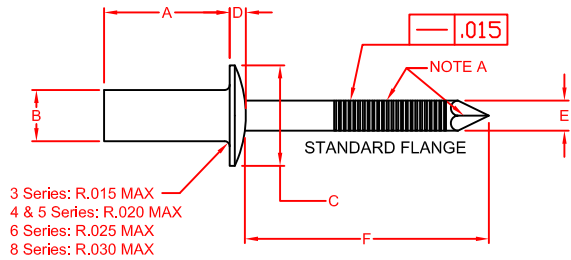

3 Series: R.015 MAX
 4 & 5 Series: R.020 MAX
 6 Series: R.025 MAX
 8 Series: R.030 MAX

NOTE A: MANDREL POINT AND GROOVE PATTERN PER RIVETKING STANDARD

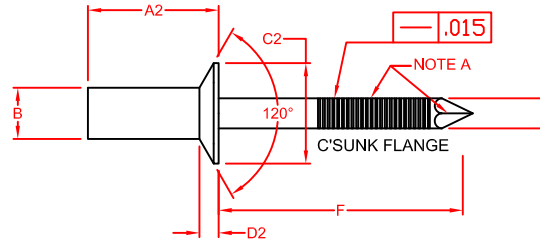

NOTE A: MANDREL POINT AND GROOVE PATTERN PER RIVETKING STANDARD

SIZE	GRIP RANGE	A		B	E	F	PERFORMANCE	
		RIVET LENGTH	RIVET LENGTH				SHEAR LBS. F	TENSILE LBS. F
3/32	.020 .125	.250	.280	.096	.061	1.00	90	120
		MAX	MAX					
	.126 .250	.375	.400					
		MAX	MAX					
1/8	.020 .062	.297	.332	.128	.074	1.00	240	280
		MAX	MAX					
	.063 .125	.360	.395					
		MAX	MAX					
5/32	.126 .187	.422	.457	.122	.066	MIN.	MIN.	MIN.
		MAX	MAX					
	.188 .250	.485	.520					
		MAX	MAX					
3/8	.251 .312	.547	.582	.159	.092	1.06	350	480
		MAX	MAX					
	.313 .375	.610	.645					
		MAX	MAX					
7/16	.376 .500	.735	.770	.183	.110	1.06	500	690
		MAX	MAX					
	.020 .125	.406	.471					
		MAX	MAX					
1/2	.126 .187	.468	.538	.191	.102	MIN.	MIN.	MIN.
		MAX	MAX					
	.188 .250	.531	.601					
		MAX	MAX					
3/4	.251 .375	.656	.736	.255	.146	1.25	900	1100
		MAX	MAX					
	.376 .500	.781	.851					
		MAX	MAX					
1	.501 .625	.906	1.026	.246	.138	MIN.	MIN.	MIN.
		MAX	MAX					
	.626 .750	1.026	1.101					
		MAX	MAX					
1 1/4	.020 .125	.445	.525	.255	.146	1.25	900	1100
		MAX	MAX					
	.126 .250	.570	.650					
		MAX	MAX					
1 1/2	.251 .375	.695	.775	.246	.138	MIN.	MIN.	MIN.
		MAX	MAX					
	.376 .500	.820	.900					
		MAX	MAX					
1 3/4	.501 .625	.945	1.025	.246	.138	MIN.	MIN.	MIN.
		MAX	MAX					
	.626 .750	1.070	1.150					
		MAX	MAX					
2	.751 .875	1.195	1.275	.246	.138	MIN.	MIN.	MIN.
		MAX	MAX					
	.876 1.000	1.320	1.400					
		MAX	MAX					

PART NUMBER	STANDARD FLANGE - DOME HEAD		COUNTERSUNK FLANGE	
	C HEAD DIA.	D HEAD HEIGHT	C2 HEAD DIA.	D2 HEAD HEIGHT
SBS 32 CE	.198	.032	SCS 32 CE	.187
SBS 34 CE	.178	.022	SCS 34 CE	.161
SBS 41 CE	.252	.050	SCS 41 CE	.027
SBS 42 CE			SCS 42 CE	
SBS 43 CE			SCS 43 CE	
SBS 44 CE			SCS 44 CE	
SBS 45 CE	.224	.040	SCS 45 CE	.245
SBS 46 CE	.328	.065	SCS 46 CE	.221
SBS 48 CE			SCS 48 CE	
SBS 52 CE			SCS 52 CE	
SBS 53 CE			SCS 53 CE	
SBS 54 CE	.296	.055	SCS 54 CE	.328
SBS 55 CE	.394	.080	SCS 55 CE	.296
SBS 56 CE			SCS 56 CE	
SBS 58 CE			SCS 58 CE	
SBS 62 CE			SCS 62 CE	
SBS 63 CE	.356	.070	SCS 63 CE	.394
SBS 64 CE			SCS 64 CE	
SBS 66 CE			SCS 66 CE	
SBS 68 CE			SCS 68 CE	
SBS 610CE	.525	.100	SCS 610CE	.356
SBS 612CE			SCS 612CE	
SBS 82 CE			SCS 82 CE	
SBS 84 CE			SCS 84 CE	
SBS 86 CE	.475	.090	SCS 86 CE	.525
SBS 88 CE			SCS 88 CE	
SBS 810CE			SCS 810CE	
SBS 812CE			SCS 812CE	
SBS 814CE	.525	.080	SCS 814CE	.475
SBS 816CE			SCS 816CE	

REVISIONS	5-18-2016	REVISED, ERROR CORRECTION
	3-18-2016	ANGLE TOLERANCE FROM 1° TO 2°
	4-12-11	REVISED, COUNTERSUNK LENGTH A.V
	01-29-10	CORRECTED TYPO
	09-29-09	INITIAL RELEASE
	DATE	DESCRIPTION
	E	REV
	D	
	C	
	B	
	A	
SURFACE TREATMENT	RIVET: Zinc Rhos MANDREL: Zinc Rhos	
HEAT TREATMENT:		
MATERIAL:	RIVET: Steel per MS-03 MANDREL: C1022-1045M Steel per MS-02 RIVETKING SPEC/MS01/MS02 & IFL Grade 30	
PROCESSING	<input type="checkbox"/> MTL RCP1 <input type="checkbox"/> COLDFORM1 <input type="checkbox"/> ANNEAL <input type="checkbox"/> FINISH <input type="checkbox"/> COLDFORM2 <input type="checkbox"/> FINISH <input type="checkbox"/> ASS'LY <input type="checkbox"/> FQC <input type="checkbox"/> PACK	
DRAWN: SBS	DATE: 4-1-08	CHECKED: JGE
DESCRIPTION: ALL STEEL BLIND RIVETS		
LIMITS UNLESS STATED	DIMENSIONS IN INCHES UNLESS OTHERWISE STATED. METRIC DIMENSIONS IN PARENTHESES. ALL DIMENSIONS TO UNLESS OTHERWISE SPECIFIED. ALL DIMENSIONS TO UNLESS OTHERWISE SPECIFIED.	
Industrial Rivet & Fastener Co.	200 PARTS AVENUE NORTHVALE, NJ, 07647 TEL: (201) 750 1040 info@rivetking.com	
DRAWING NUMBER:	SBS-SCS/CLOSED END SERIES	REV: E
	MASTER DWG: BR-0E-2008-1	LOCK: SERVER/BLUEPRINTS/4-INTERNAL/MAST