



RivetKing® FBF-CE Series • All Stainless • Closed End

CLOSED END • RIVET: 18-8 STAINLESS • MANDREL: STAINLESS

STANDARD BLIND RIVETS

RIVET: DOME HEAD, POLISHED, 300 SERIES STAINLESS STEEL | MANDREL: POLISHED, 400 SERIES STAINLESS STEEL | PER IFI-126 GRADE 51
 300 SERIES STAINLESS STEEL MANDREL/ 300 SERIES STAINLESS STEEL RIVET • AVAILABLE ON REQUEST BY SPECIAL ORDER ONLY

Closed End Rivets are used when a weather proof / leak proof seal is needed. Its completely closed end design prevents liquids, moisture, air and other contaminants from entering the riveted hole and/or the rivet itself. The RivetKing® Closed End rivet design guarantees the mandrel head is fully retained within the rivet. Stainless/Stainless Closed End rivets are bright polished and contain a grooved mandrel which improves jaw life and maintains positive stroke of the riveter. The All-Stainless configuration is corrosion resistant.

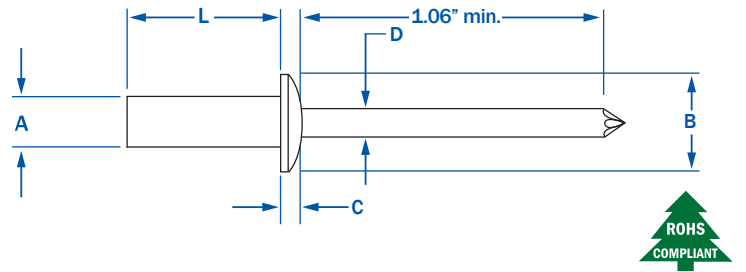

PART NUMBER	RIVET SIZE	GRIP RANGE MIN - MAX	L LENGTH MAX	B HEAD DIA NOM.	C HEAD HEIGHT NOM.	D MANDREL DIA NOM.	HOLE SIZE MIN - MAX	SHEAR LBS.F	TENSILE LBS.F
FBF - 42 - CE	1/8"	.063 - .125	.360	.250	.040	.076	.129 - .133 (#30)	400	450
FBF - 43 - CE		.126 - .187	.422						
FBF - 44 - CE		.188 - .250	.485						
FBF - 45 - CE		.251 - .312	.547						
FBF - 46 - CE		.313 - .375	.610						
FBF - 48 - CE		.376 - .500	.735						
FBF - 52 - CE	5/32"	.020 - .125	.375	.312	.050	.095	.160 - .164 (#20)	700	800
FBF - 53 - CE		.126 - .187	.437						
FBF - 54 - CE		.188 - .250	.500						
FBF - 56 - CE		.251 - .375	.625						
FBF - 58 - CE		.376 - .500	.750						
FBF - 510 - CE		.501 - .625	.875						
FBF - 62 - CE	3/16"	.020 - .125	.406	.375	.060	.114	.192 - .196 (#11)	850	900
FBF - 63 - CE		.126 - .187	.468						
FBF - 64 - CE		.188 - .250	.531						
FBF - 66 - CE		.251 - .375	.656						
FBF - 68 - CE		.376 - .500	.781						
FBF - 610 - CE		.501 - .625	.906						
FBF - 612 - CE		.626 - .750	1.026						
FBF - 82 - CE	1/4"	.020 - .125	.445	.500	.080	.151	.257 - .261 (F)	1520	1955
FBF - 84 - CE		.125 - .250	.570						
FBF - 86 - CE		.251 - .375	.695						
FBF - 88 - CE		.376 - .500	.820						
FBF - 810 - CE		.501 - .625	.945						
FBF - 812 - CE		.626 - .750	1.070						
FBF - 814 - CE		.751 - .875	1.195						
FBF - 816 - CE		.876 - 1.000	1.320						

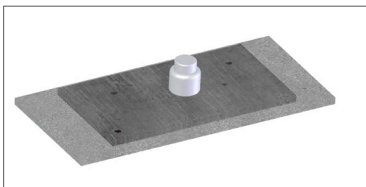

* 1/4" Diameter rivets have a 1.250 mandrel length minimum.