



# RivetKing® SupraBolt™

STEEL/STEEL

THE FOLLOWING PRODUCT IS COVERED UNDER PATENT AND/OR TRADEMARK PROTECTIONS

A high strength industrial blind bolt that is oversized and mechanically locked to insure clamp load in structural applications. It saves assembly time by allowing assembly from one side of the application. Common applications are vehicle chassis (military, truck, train) and racking systems (solar panel, pallet racking). Often times the strength of SupraBolt™ can replace welding or high strength threaded fasteners and is tamper resistant.

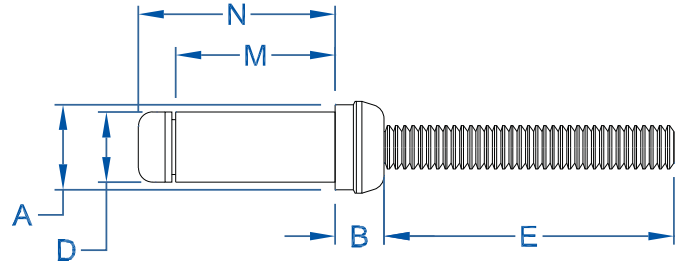

**MINIMUM VALUES IN NOMINAL GRIP\*\***

PART NUMBER	DIAMETER	GRIP RANGE	A	B	C	D	E	M	N	SHEAR	TENSILE	HOLE DIAMETER
					MAX.			REF.	MAX.			
RB6-2	3/16"	.093-.156	.276-.286	.152-.168	.015	.196-.206	.785	.376	.500	2800	1800	.208-.222
RB6-3	3/16"	.157-.219	.276-.286	.152-.168	.015	.196-.206	.785	.439	.562	2800	1800	.208-.222
RB6-4	3/16"	.220-.281	.276-.286	.152-.168	.015	.196-.206	.785	.501	.625	2800	1800	.208-.222
RB6-5	3/16"	.282-.344	.276-.286	.152-.168	.015	.196-.206	.785	.564	.687	2800	1800	.208-.222
RB6-6	3/16"	.345-.406	.276-.286	.152-.168	.015	.196-.206	.785	.626	.750	2800	1800	.208-.222
RB6-7	3/16"	.407-.469	.276-.286	.152-.168	.015	.196-.206	.785	.689	.812	2800	1800	.208-.222
RB6-8	3/16"	.470-.531	.276-.286	.152-.168	.015	.196-.206	.785	.751	.875	2800	1800	.208-.222
RB6-9	3/16"	.532-.594	.276-.286	.152-.168	.015	.196-.206	.785	.814	.937	2800	1800	.208-.222
RB6-10	3/16"	.595-.656	.276-.286	.152-.168	.015	.196-.206	.785	.876	1.000	2800	1800	.208-.222
RB6-11	3/16"	.657-.719	.276-.286	.152-.168	.015	.196-.206	.785	.939	1.062	2800	1800	.208-.222
RB6-12	3/16"	.720-.781	.276-.286	.152-.168	.015	.196-.206	.785	1.001	1.125	2800	1800	.208-.222
RB8-2	1/4"	.093-.156	.368-.380	.205-.225	.020	.262-.275	.860	.460	.620	5100	3250	.277-.292
RB8-3	1/4"	.157-.219	.368-.380	.205-.225	.020	.262-.275	.860	.523	.682	5100	3250	.277-.292
RB8-4	1/4"	.220-.281	.368-.380	.205-.225	.020	.262-.275	.860	.585	.745	5100	3250	.277-.292
RB8-5	1/4"	.282-.344	.368-.380	.205-.225	.020	.262-.275	.860	.648	.807	5100	3250	.277-.292
RB8-6	1/4"	.345-.406	.368-.380	.205-.225	.020	.262-.275	.860	.710	.870	5100	3250	.277-.292
RB8-7	1/4"	.407-.469	.368-.380	.205-.225	.020	.262-.275	.860	.773	.932	5100	3250	.277-.292
RB8-8	1/4"	.470-.531	.368-.380	.205-.225	.020	.262-.275	.860	.835	.995	5100	3250	.277-.292
RB8-9	1/4"	.532-.594	.368-.380	.205-.225	.020	.262-.275	.860	.898	1.057	5100	3250	.277-.292
RB8-10	1/4"	.595-.656	.368-.380	.205-.225	.020	.262-.275	.860	.960	1.120	5100	3250	.277-.292
RB8-11	1/4"	.657-.719	.368-.380	.205-.225	.020	.262-.275	.860	1.023	1.182	5100	3250	.277-.292
RB8-12	1/4"	.720-.781	.368-.380	.205-.225	.020	.262-.275	.860	1.085	1.245	5100	3250	.277-.292
RB10-4	5/16"	.188-.312	.468-.478	.266-.278	.025	.332-.346	1.285	.695	.875	8050	5200	.348-.368
RB10-6	5/16"	.313-.437	.468-.478	.266-.278	.025	.332-.346	1.285	.820	1.000	8050	5200	.348-.368
RB10-8	5/16"	.438-.562	.468-.478	.266-.278	.025	.332-.346	1.285	.945	1.125	8050	5200	.348-.368
RB10-10	5/16"	.563-.687	.468-.478	.266-.278	.025	.332-.346	1.285	1.070	1.250	8050	5200	.348-.368
RB10-12	5/16"	.688-.812	.468-.478	.266-.278	.025	.332-.346	1.285	1.195	1.375	8050	5200	.348-.368
RB10-14	5/16"	.813-.937	.468-.478	.266-.278	.025	.332-.346	1.285	1.320	1.500	8050	5200	.348-.368
RB10-16	5/16"	.938-1.062	.468-.478	.266-.278	.025	.332-.346	1.285	1.445	1.625	8050	5200	.348-.368
RB12-4	3/8"	.188-.312	.553-.563	.315-.327	.030	.393-.411	1.230	.766	.969	11100	7250	.413-.435
RB12-6	3/8"	.313-.437	.553-.563	.315-.327	.030	.393-.411	1.230	.891	1.094	11100	7250	.413-.435
RB12-8	3/8"	.438-.562	.553-.563	.315-.327	.030	.393-.411	1.230	1.016	1.219	11100	7250	.413-.435
RB12-10	3/8"	.563-.687	.553-.563	.315-.327	.030	.393-.411	1.230	1.141	1.344	11100	7250	.413-.435
RB12-12	3/8"	.688-.812	.553-.563	.315-.327	.030	.393-.411	1.230	1.266	1.469	11100	7250	.413-.435
RB12-14	3/8"	.813-.937	.553-.563	.315-.327	.030	.393-.411	1.230	1.391	1.594	11100	7250	.413-.435
RB12-16	3/8"	.938-1.062	.553-.563	.315-.327	.030	.393-.411	1.230	1.516	1.719	11100	7250	.413-.435
RB12-18	3/8"	1.063-1.187	.553-.563	.315-.327	.030	.393-.411	1.230	1.641	1.844	11100	7250	.413-.435
RB12-20	3/8"	1.188-1.312	.553-.563	.315-.327	.030	.393-.411	1.230	1.766	1.969	11100	7250	.413-.435

\*\*These are minimum shear and tensile strengths, in pounds, of installed fasteners, when tested in a grip equal to or greater than one and one half the fastener diameter.