

RIVETKING® BLIND RIVETS - OPEN END ALUMINUM/ALUMINUM

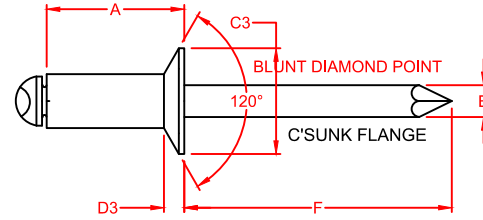
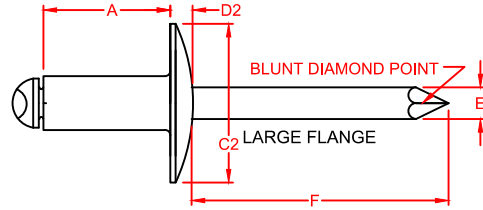
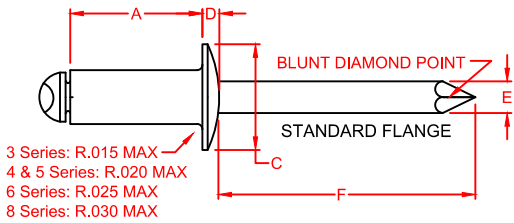

RIVET DIA. NOM.	SIZE	GRIP RANGE		A LENGTH MAX	B BODY DIA.	E MANDREL DIA. NOM.	F MANDREL PROTRUDE MIN.	SHEAR LBS.F MIN.	TENSILE LBS.F MIN.						
		MIN	MAX												
3/32"	32	.020	.125	.250	.096	.057	1.00	70	80						
	34	.126	.250	.375	.090										
1/8"	41	.020	.062	.212	.128 .122	.076	1.00	120	150						
	42	.063	.125	.275											
	43	.126	.187	.337											
	44	.126*	.250	.400											
	45	.251	.312	.462											
	46	.251	.375	.525											
	48	.376	.500	.650											
	410	.501	.625	.775											
5/32"	52	.020	.125	.300	.159 .153	.096	1.06	190	230						
	53	.126	.187	.362											
	54	.126*	.250	.425											
	56	.251	.375	.550											
	58	.376	.500	.675											
	510	.501	.625	.800											
3/16"	62	.020	.125	.325	.191 .183	.114	1.06	260	320						
	63	.126	.187	.387											
	64	.126*	.250	.450											
	66	.251	.375	.575											
	68	.376	.500	.700											
	610	.501	.625	.825											
	612	.626	.750	.950											
	614	.751	.875	1.075											
	616	.876	1.000	1.200											
	620	1.126	1.250	1.450											
	1/4"	82	.020	.125						.375	.255 .246	.151	1.25	460	560
		84	.126	.250						.500					
86		.251	.375	.625											
88		.376	.500	.750											
810		.501	.625	.875											
812		.626	.750	1.000											
814		.751	.875	1.125											
816		.876	1.000	1.250											
818		1.001	1.125	1.375											
820		1.126	1.250	1.500											

STANDARD FLANGE - DOME HEAD		
PART NUMBER	C HEAD DIA.	D HEAD HT. MAX.
	ABA 32 /IR	.198
ABA 34 /IR	.178	
ABA 41 /IR		
ABA 42 /IR		
ABA 43 /IR		
ABA 44 /IR	.262	.040
ABA 45 /IR	.238	
ABA 46 /IR		
ABA 48 /IR		
ABA 410 /IR		
ABA 52 /IR		
ABA 53 /IR		
ABA 54 /IR		
ABA 56 /IR	.328	.050
ABA 58 /IR	.296	
ABA 510 /IR		
ABA 512 /IR		
ABA 62 /IR		
ABA 63 /IR		
ABA 64 /IR		
ABA 66 /IR		
ABA 68 /IR	.394	.060
ABA 610 /IR	.356	
ABA 612 /IR		
ABA 614 /IR		
ABA 616 /IR		
ABA 620 /IR		
ABA 82 /IR		
ABA 84 /IR		
ABA 86 /IR		
ABA 88 /IR		
ABA 810 /IR	.525	.080
ABA 812 /IR	.475	
ABA 814 /IR		
ABA 816 /IR		
ABA 818 /IR		
ABA 820 /IR		

LARGE FLANGE - DOME HEAD		
PART NUMBER	C2 HEAD DIA.	D2 HEAD HT. MAX.
	ABA 32LF /IR	.293
ABA 34LF /IR	.269	
ABA 41LF /IR		
ABA 42LF /IR		
ABA 43LF /IR		
ABA 44LF /IR	.390	.065
ABA 45LF /IR	.360	
ABA 46LF /IR		
ABA 48LF /IR		
ABA 410LF /IR		
ABA 52LF /IR		
ABA 53LF /IR		
ABA 54LF /IR		
ABA 56LF /IR	.488	.075
ABA 58LF /IR	.448	
ABA 510LF /IR		
ABA 512LF /IR		
ABA 62LF /IR		
ABA 63LF /IR		
ABA 64LF /IR		
ABA 66LF /IR		
ABA 68LF /IR	.650	.092
ABA 610LF /IR	.600	
ABA 612LF /IR		
ABA 614LF /IR		
ABA 616LF /IR		
ABA 620LF /IR		
ABA 82LF /IR		
ABA 84LF /IR		
ABA 86LF /IR		
ABA 88LF /IR		
ABA 810LF /IR	.780	.107
ABA 812LF /IR	.720	
ABA 814LF /IR		
ABA 816LF /IR		
ABA 818LF /IR		
ABA 820LF /IR		

COUNTERSUNK HEAD		
PART NUMBER	C3 HEAD DIA.	D3 HEAD HT. REF.
	ACA 32 /IR	.187
ACA 34 /IR	.161	
ACA 41 /IR		
ACA 42 /IR		
ACA 43 /IR		
ACA 44 /IR	.233	.031
ACA 45 /IR	.207	
ACA 46 /IR		
ACA 48 /IR		
ACA 410 /IR		
ACA 52 /IR		
ACA 53 /IR		
ACA 54 /IR		
ACA 56 /IR	.294	.040
ACA 58 /IR	.268	
ACA 510 /IR		
ACA 512 /IR		
ACA 62 /IR		
ACA 63 /IR		
ACA 64 /IR		
ACA 66 /IR		
ACA 68 /IR	.361	.050
ACA 610 /IR	.335	
ACA 612 /IR		
ACA 614 /IR		
ACA 616 /IR		
ACA 620 /IR		
ACA 82 /IR		
ACA 84 /IR		
ACA 86 /IR		
ACA 88 /IR		
ACA 810 /IR	.484	.060
ACA 812 /IR	.456	
ACA 814 /IR		
ACA 816 /IR		
ACA 818 /IR		
ACA 820 /IR		

CONFIDENTIALITY -
THIS DRAWING AND THE INFORMATION IT CONTAINS ARE THE SOLE PROPERTY OF INDUSTRIAL RIVET & FASTENER CO. THIS DRAWING IS USED A SELLING AND/OR MANUFACTURING DEVICE WHICH MAY CONTAIN INFORMATION THAT IS PATENTED OR TRADEMARKED BY THE INDUSTRIAL RIVET & FASTENER CO. REPRODUCTION OR DISCLOSURE BY ANYONE, OF ANY PART OF THIS DRAWING OR INFORMATION THEREIN OR THE USE THEREOF FOR MAKING OTHER DRAWINGS AND/OR PRODUCTS IS STRICTLY PROHIBITED WITHOUT PRIOR WRITTEN CONSENT OF THE INDUSTRIAL RIVET & FASTENER CO.

CONTINUOUS IMPROVEMENT
INDUSTRIAL RIVET & FASTENER CO. HAS CONTINUOUS IMPROVEMENT POLICIES/PROCEDURES IN PLACE AND THEREFORE RESERVES THE RIGHT TO CORRECT, CHANGE OR IMPROVE PRODUCTS AND/OR SPECIFICATIONS WITHOUT NOTICE, UNLESS DESIGNATED BY AN S-XXXX SUFFIX AS PART OF THE PART NUMBER. RESPONSIBILITY DUE TO DATA TABLE TYPOGRAPHICAL ERRORS ARE LIMITED TO THE CORRECTION AND RESUBMISSION OF THE DRAWING.

DRAWN: S. SHERMAN		DATE: 4-1-08	CHECKED: ZA/SS	SHEET 1 OF 1	ALUMINUM/ALUMINUM OPEN END BLIND RIVETS		 RIVET KING 200 PARIS AVENUE NORTHVALE, NJ, 07647 TEL: (201) 750 1040 info@rivet.com		DIMENSIONS IN INCHES UNLESS OTHERWISE STATED. METRIC DIMENSIONS IN PARENTHESES REMOVE ALL BURRS AND SHARP EDGES		DECIMAL UNLESS STATED ±.015 ANGULAR ±2° SURFACE TEXTURE	ORIGINAL SHEET SIZE 8.5" X 11"	INDUSTRIAL RIVET & FASTENER CO.	DRAWING NUMBER:	ABA-ACA SERIES	MASTER DWG: BR-DE-2008-1	LOCN: SERVER/BLUEPRINTS/4-INTERNAL/PAST	H REV	2022 REVIEW, IFI ALIGNMENT, TYPO CORRECTION	1-1-2022 DATE
SURFACE TREATMENT		RIVET: Bright Polish MANDREL: Bright Polish																		
HEAT TREATMENT:		N/R																		
MATERIAL:		RIVET: 5052M Aluminum per MS-01 MANDREL: 5056/LA-03 Aluminum per MS-01 SPEC# IFI Grade 11 RIVETKING# MS-01																		
PROCESSING		MTL RCPT COLDFORM1 STRAIN RELIEF FINISH COLDFORM2 FINISH ASS'LY FOC PACK																		