

# RIVETKING® BLIND RIVETS - CLOSED END ALUMINUM / ALUMINUM

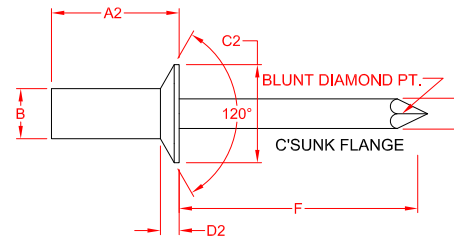
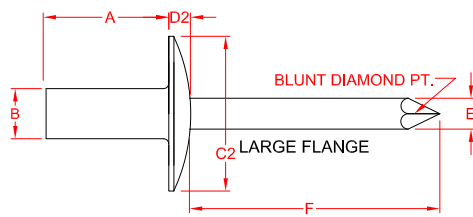
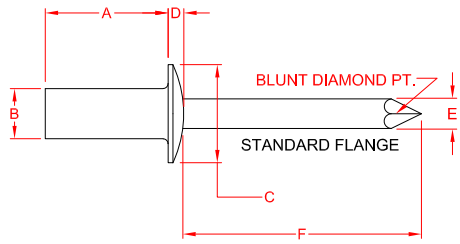

MANUFACTURED IN ACCORDANCE WITH RIVETKING MATERIAL, PROCESSING AND TESTING REQUIREMENTS

RIVET Ø	SIZE CODE	GRIP RANGE		BODY		MANDREL		PERFORMANCE	
				LENG.	BODY Ø	WIRE Ø	O/H LENG.	SHEAR LBS.F	TENSILE LBS.F
		NOM.	SIZE	MIN	MAX	MAX	Ø	MAX.	MIN.
3/32"	32	.020	.125	-	.096	.057	1.00	-	-
	34	.126	.250	-	.090				
1/8"	41	.020	.062	.297	.128	.074	1.00	100	110
	42	.063	.125	.360					
	43	.126	.187	.422					
	44	.188	.250	.485					
	45	.251	.312	.547					
	46	.251	.375	.610					
	48	.376	.500	.735					
	410	.501	.625	.760					
5/32"	52	.020	.125	.375	.159	.092	1.06	130	160
	53	.126	.187	.437					
	54	.188	.250	.500					
	56	.313	.375	.562					
	58	.376	.500	.625					
	510	.501	.625	.750					
	512	.626	.750	.875					
3/16"	62	.020	.125	.406	.191	.110	1.06	210	250
	63	.126	.187	.468					
	64	.126*	.250	.531					
	66	.251	.375	.656					
	68	.376	.500	.781					
	610	.501	.625	.906					
	612	.626	.750	1.026					
1/4"	82	.020	.125	.445	.255	.146	1.25	-	-
	84	.126	.250	.570					
	86	.251	.375	.695					
	88	.376	.500	.820					
	810	.501	.625	.945					
	812	.626	.750	1.070					

PART NUMBER	STANDARD FLANGE	
	C	D
	BODY	
	HEAD DIA.	HEAD HT.
	MAX.	MAX.
ABA 32CE /IR	.198	.032
ABA 34CE /IR	.178	.032
ABA 41CE /IR		
ABA 42CE /IR		
ABA 43CE /IR		
ABA 44CE /IR	.252	.050
ABA 45CE /IR	.224	.050
ABA 46CE /IR		
ABA 48CE /IR		
ABA 410CE /IR		
ABA 52CE /IR		
ABA 53CE /IR		
ABA 54CE /IR		
ABA 56CE /IR	.328	.065
ABA 58CE /IR	.296	.065
ABA 510CE /IR		
ABA 512CE /IR		
ABA 62CE /IR		
ABA 63CE /IR		
ABA 64CE /IR		
ABA 66CE /IR	.394	.080
ABA 68CE /IR	.356	.080
ABA 610CE /IR		
ABA 612CE /IR		
ABA 82CE /IR		
ABA 84CE /IR		
ABA 86CE /IR	.525	.100
ABA 88CE /IR	.475	.100
ABA 810CE /IR		
ABA 812CE /IR		

PART NUMBER	LARGE FLANGE	
	C2	D2
	BODY	
	HEAD DIA.	HEAD HT.
	MAX.	MAX.
ABA 32CELF /IR	.293	.065
ABA 34CELF /IR	.269	.065
ABA 41CELF /IR		
ABA 42CELF /IR		
ABA 43CELF /IR		
ABA 44CELF /IR	.390	.075
ABA 45CELF /IR	.360	.075
ABA 46CELF /IR		
ABA 48CELF /IR		
ABA 410CELF /IR		
ABA 52CELF /IR		
ABA 53CELF /IR		
ABA 54CELF /IR		
ABA 56CELF /IR	.488	.085
ABA 58CELF /IR	.448	.085
ABA 510CELF /IR		
ABA 512CELF /IR		
ABA 62CELF /IR		
ABA 63CELF /IR		
ABA 64CELF /IR		
ABA 66CELF /IR	.650	.095
ABA 68CELF /IR	.600	.095
ABA 610CELF /IR		
ABA 612CELF /IR		
ABA 82CELF /IR		
ABA 84CELF /IR		
ABA 86CELF /IR	.780	.110
ABA 88CELF /IR	.720	.110
ABA 810CELF /IR		
ABA 812CELF /IR		

PART NUMBER	COUNTERSUNK HEAD		
	A2	C3	D3
	BODY		
	LENG.	HEAD DIA.	HEAD HT.
	MAX.	MAX.	MAX.
ACA 32CE /IR	-	.187	.027
ACA 34CE /IR	-	.161	.027
ACA 41CE /IR	.332		
ACA 42CE /IR	.395		
ACA 43CE /IR	.457		
ACA 44CE /IR	.520	.245	.042
ACA 45CE /IR	.582	.221	.042
ACA 46CE /IR	.645		
ACA 48CE /IR	.770		
ACA 410CE /IR	.915		
ACA 52CE /IR	.425		
ACA 53CE /IR	.487		
ACA 54CE /IR	.550	.328	.051
ACA 56CE /IR	.675	.296	.051
ACA 58CE /IR	.800		
ACA 510CE /IR	.925		
ACA 512CE /IR	1.050		
ACA 62CE /IR	.471		
ACA 63CE /IR	.538		
ACA 64CE /IR	.601	.394	.060
ACA 66CE /IR	.736	.356	.060
ACA 68CE /IR	.851		
ACA 610CE /IR	1.026		
ACA 612CE /IR	1.101		
ACA 82CE /IR	.525		
ACA 84CE /IR	.650		
ACA 86CE /IR	.775	.525	.080
ACA 88CE /IR	.900	.475	.080
ACA 810CE /IR	1.025		
ACA 812CE /IR	1.150		

**CONFIDENTIALITY -** THIS DRAWING AND THE INFORMATION IT CONTAINS ARE THE SOLE PROPERTY OF INDUSTRIAL RIVET & FASTENER CO. THIS DRAWING IS USED AS A SELLING AND/OR MANUFACTURING DEVICE WHICH MAY CONTAIN INFORMATION THAT IS PATENTED OR TRADEMARKED BY THE INDUSTRIAL RIVET & FASTENER CO. REPRODUCTION OR DISCLOSURE BY ANYONE, OF ANY PART OF THIS DRAWING OR INFORMATION THEREIN OR THE USE THEREOF FOR MAKING OTHER DRAWINGS AND/OR PRODUCTS IS STRICTLY PROHIBITED WITHOUT PRIOR WRITTEN CONSENT OF THE INDUSTRIAL RIVET & FASTENER CO.

**CONTINUOUS IMPROVEMENT -** INDUSTRIAL RIVET AND FASTENER CO. HAS CONTINUOUS IMPROVEMENT POLICIES/PROCEDURES IN PLACE AND THEREFORE RESERVES THE RIGHT TO CORRECT, CHANGE OR IMPROVE PRODUCTS AND/OR SPECIFICATIONS WITHOUT NOTICE, UNLESS DESIGNATED BY AN S-XXXX SUFFIX AS PART OF THE PART NUMBER. RESPONSIBILITY DUE TO DATA TABLE TYPOGRAPHICAL ERRORS ARE LIMITED TO THE CORRECTION AND RESUBMISSION OF THE DRAWING.

DATE: 4-1-08	CHECKED: ZAIS	SHEET 1 OF 1	REVISIONS
DRAWN: S. SHERMAN			ALUMINUM/ALUMINUM CLOSED END BLIND RIVETS
DECIMAL LIMITS STATED	ANGULAR LIMITS STATED	SURFACE TEXTURE	REVISIONS
±.015 ±2°	1/8" (15°)		
DIMENSIONS IN INCHES UNLESS OTHERWISE STATED; METRIC DIMENSIONS IN PARENTHESES			
ORIGINAL SHEET SIZE 16.5" X 11"			
200 PARIS AVENUE NORTHVALE, NJ 07647 TEL: (201) 750 1040 info@rivet.com			
<b>Industrial Rivet &amp; Fastener Co.</b>			
DRAWING NUMBER: ABA-CE, ABA-CELF, ACA-CE			
MASTER DWG: BR-02-2008-1   LOCN: SERVER/BLUEPRINTS/4-INTERNAL/MAST			
SURFACE TREATMENT: RIVET: Polished MANDREL: Polished			
HEAT TREATMENT: RELIEF			
MATERIAL: RIVET: 1100 Aluminum per MS-01 MANDREL: LA-03 Aluminum per MS-01 SPEC# IFI Grade 9 RIVETKING# MS-01			
MTL RCP T COLDFORM1 COLDFORM2 COLDFORM2 FINISH ASS'LY FOC PACK			
RELIEF FINISH FOC PACK			
REV:			
NEW FORMAT & ALIGN TO IFI			
DESCRIPTION			
11-22-2022			
DATE			