

RIVETKING® STRUCTURAL RIVETS





RivetKing® Timeline

Founded in 1912, Industrial Rivet & Fastener Company has grown from a primarily local operation with four employees to a global distributor, manufacturer and importer with nine international locations, 10 U.S. distribution centers and 48 employees serving customers both around the corner and across the globe.

1912

Established in NYC as a supplier to NY Port Authority for bridges, representing Bethlehem Steel in the NYC area



1914

Began carrying stock to support demand

1944

Developed specialty fasteners to support war efforts

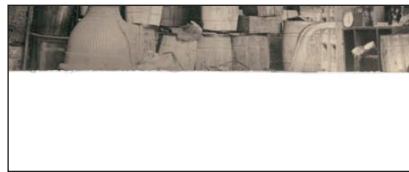

1930

Expanded product line to smaller diameter products

1950

First documented evidence that IRFCO became known and named by its customers as the "RivetKing"



1962

Sales and marketing developed the RivetKing brand into an entire product line

1968

General Rivet Manufacturing opened for business and would ultimately be purchased by IRFCO in 1992. General Rivet manufactured solid and semitubular rivets and developed a semitubular product line for small electronics.



1975

Established IRF Taiwan as manufacturing arm for production

1998

Moved corporate headquarters to Northvale, NJ combining manufacturing and distribution functions. Became ISO9001



2000

Expanded product line to include blind rivets and blind threaded inserts. Established warehousing in Mexico

2009

IRF Germany opened



2005

10 new domestic warehouses opened in Texas, California, Kansas City, Canada, Denver, Salt Lake City, and Chicago

2010

Developed the database logging and live retrieval of force testing, dimensional inspection and salt spray testing data

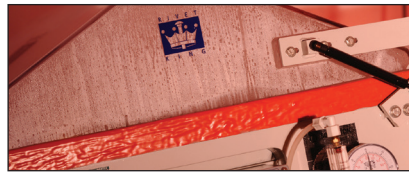

2008

Significant technology upgrade to conform to ISO 17025 in quality control and engineering, including purchase of salt spray, force, and micro hardness testing equipment. All quality systems conform to ISO/TS 16949 and ISO17025

2011

IRF Japan and IRF Australia opened



2012

100 Year Anniversary
Launch of Green Initiative



RivetKing® QUALITY SERVICES

Performance Testing Capabilities

RivetKing® products are quality tested on state of the art inspection equipment. Our capabilities include Salt Spray Testing, Shear Testing, Tensile Testing, Pushout Testing, Mandrel Retention Testing and Lock Strength Testing. Data is gathered across production lots and retained on file for 3 years. Graphic representations of performance are available and provided upon request. Product/Lot/Competitor comparisons are performed regularly.

FORCE TESTING

When needed, we can measure a rivets performance with our MTM, a machine used to detect force. The resulting curve plots load force needed to set or break a rivet. This fingerprint allows us to more exactly determine the holding power of the riveted assembly and/or further evaluate its performance. We can detect small differences in performance and its results go directly to R & D to further improve the performance of our product, and yours.

SALT FOG TESTING

On a regular basis we check all spec finishes with our advanced salt spray testing equipment. Nationally rated and quality certified, we provide test results to measure the effectiveness of our finishes, before and after riveting as necessary. Temperatures are controlled and monitored 24 hours a day, 365 days a year via our windows based control software. Reports are generated regularly for internal use and for customers.



TENSILE TESTING



BREAKLOAD TESTING



SHEAR TESTING



LOCKFORCE TESTING



MANDREL RETENTION TESTING



FORCE TESTING
IFI135 & ISO 14589



SALT SPRAY TESTING
ASTMB117-07A & ISO 9227

WE ARE HERE FOR YOU

Our trained personnel are here to serve our customers. If you have any questions, please call our quality control department or one of our applications engineers. Tap into our capabilities, we're here to serve you.

Industrial Rivet & Fastener Co.
200 Paris Avenue
Northvale, New Jersey 07647
U.S.A.

Tel: (201) 750-1040
Fax: (201) 750-1050
www.rivet.com

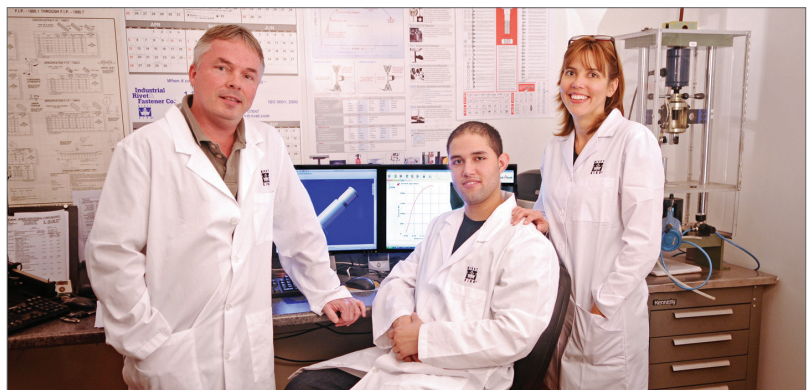



RivetKing® Product Overview

BLIND RIVETS • COLLAR BOLTS • RIVET NUTS • TOOLS • QUICKRIVETS • DRIVE RIVETS

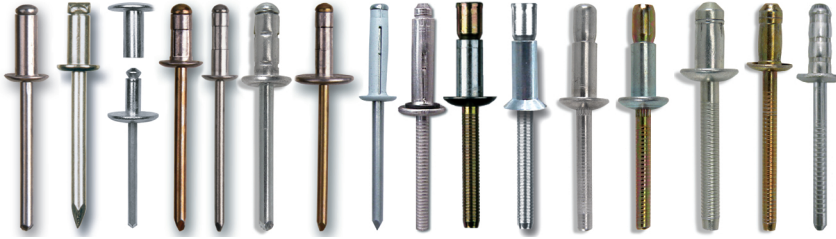

	LIGHT DUTY	MEDIUM DUTY	HEAVY DUTY (STRUCTURAL)	FIXED HOLE SIZE	VARIABLE / OVERSIZE HOLE	FIXED GRIP RANGE	VARIABLE GRIP RANGE	EXTRA WIDE GRIP RANGE	WEATHER RESISTANT / WATERTIGHT	FASTENING TO METAL	FOR THIN, SOFT OR BRITTLE MATERIALS	FASTENING TO WOOD	INTERNALLY LOCKED MANDREL (HIDDEN)	INTERNALLY LOCKED MANDREL (VISIBLE)	EXTERNALLY LOCKED MANDREL	NON-MECHANICAL LOCKED MANDREL	AESTHETIC BACKSIDE PORTRUSION	REMOVABLE	INCREASED ASSEMBLY SPEED
STANDARD BLIND RIVETS																			
OPEN END				◆		◆	◆			◆									
CLOSED END				◆		◆	◆			◆									
MULTIGRIP™ RIVETS																			
MULTI-GRIP-RT™ / MULTI-GRIP-CT™				◆		◆	◆			◆									
TRI-FOLDING / LOAD SPREADING RIVETS																			
TRIFIX™				◆		◆	◆			◆	◆								
SUPERTRIFIX™				◆		◆	◆			◆	◆								
STRUCTURAL BLIND RIVETS																			
TIGERBOLT®																			
IN-LOCK®																			
STEMLOCK™																			
RIVBOLT™																			
SEMI-STRUCTURAL BLIND RIVETS																			
RKQ™																			
RIVEX®																			
RIVINOX® / RIVIBULB®																			
EXTRA WIDE GRIP RIVETS																			
CHECKMATE®																			
TUBERIVETS™																			
SPECIALITY BLIND RIVETS																			
GENTLESET™																			
EASY ENTRY™																			
GROOVED RIVETS																			
PLR™ RIVETS																			
QUIKSNAP®																			
SPEED FASTENING™ / QUICKRIVETING																			
ZIPRIV™																			
ZIPSHO™																			
ZIPSCREW™																			
ZIPGROOVE™																			
ZIPTRONIC™																			

◆ STANDARD FEATURE ◆ APPLICATION / PRODUCT DEPENDENT

LSR LOAD® SPREADING, PEEL RIVET®, WELL-NUT®, ULTRAGRIP®, GROOVED RIVETS, JACK-NUT®, HR RIVET®, EASY ENTRY®, POPNUT®, SOFT SET®, CLOSED END, PROSET®, MULTIGRIP™, OPEN END, PRG SERIES, POPMATIC RIVET TOOLS® ARE REGISTERED TRADEMARKS OF **POP® EMHART FASTENING TECHNOLOGIES, INDUSTRIAL DIVISION, A BLACK & DECKER COMPANY**. GRIPRITE, OPEN END, CLOSED END, MULTI-GRIP®, TRI-BULB®, KLIK-LOCK®, MAGNATITE®, C6L®, KLIK RIVET NUTS®, MAGNALOK®, C50L®, KLIK-SERTS/POLYNUTS®, AUTO-BULK/MANABULB®, C120L®, 302E / 304E, STRONGHOLD™, MAGNAGRIP®, M SERIES, AUTOCLAMP®, BOM RIVET®, V SERIES, PEEL®, HUCKTAINER®, KLIK-FAST®, FLOORTITE, FI SERIES ARE REGISTERED TRADEMARKS OF **HUCK® - MARSON®, ALCOA FASTENING SYSTEMS**. AVEX®, AVIBULB®/AVINOX®, SUPERSERT®, BULBEX®, EARTH TAB RIVET, GENESIS TOOLS®, KLAMPTITE®/TLR, BRIV®, AVDEL SPEED FASTENING®, MONOBOLT®, CHOBERT®, N RIVET, INTERLOCK®, RIVSCREW®, SR RIVET, HEMLOK®, GROVIT®, Q-RIVET®, STAVEX®, CHERRYMATE®, AVTRONIC®, AVEDELOK®, MAXLOK®, CAMTAINER®, VERSANUT® ARE REGISTERED TRADEMARKS OF **AVDEL®, ACUMENT™ GLOBAL TECHNOLOGIES COMPANY, COPYRIGHT © 2007 ACUMENT™ INTELLECTUAL PROPERTIES LLC**. OPEN END, CELUSPLIT®, CEL-NUT®, CLOSED END, TIGERBOLT®, LA COBRA, MULTIGRIP™ ARE REGISTERED TRADEMARKS OF **CELUS® BRAND A RIVETKING® COMPANY**. OPEN END, CAP RIVETS®, TAURUS, POLYGRIP, TRI-FOLD®, PH SERIES, GROOVED RIVETS, BULB-TITE®, GAV SYSTEMS®, PEEL, MEGAGRIP® ARE REGISTERED TRADEMARKS OF **GESIPA® FASTENERS USA, INC. COPYRIGHT 2008®**.

AVAILABLE IN STEEL, ALUMINUM, AND STAINLESS STEEL | COMPLIANT WITH IFI 134

* Any nose piece can be used. No special requirement.

The RivetKing® In-Lock® is a structural rivet with an internal locking feature. The locking feature is not visible when the rivet is applied. The mandrel is retained within the shear plane yielding high strength under shear loads and the internal lock insures positive mandrel retention which results in high strength under pullout loads. Typically used in the manufacturing or repair of truck bodies, the In-Lock® is leak resistant and has excellent clamp-up force. The In-Lock® has a wide grip range and is offered in two diameters and two lengths. The mandrel breaks flush with the head when applied and is set without a special nose piece.

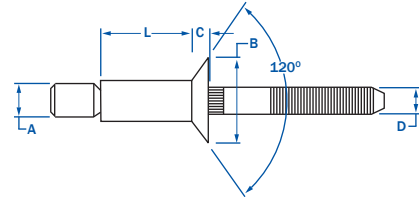
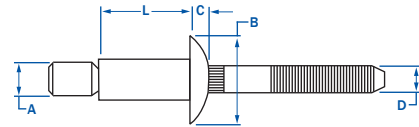

Material	PART NUMBER	RIVET SIZE	GRIP RANGE	Head Style	L	B	C	D	HOLE SIZE	SHEAR	TENSILE	MANDREL PUSHOUT
					MIN. - MAX.	MAX.	NOM.	NOM.				
ALUMINUM	ABA - 64 - STR	3/16"	.062 - .270	Dome	.415	.385	.085	.118	.191 - .201 (#10)	550	450	50
	ABA - 67 - STR		.214 - .437	Dome	.572							
	ABA - 67E - STR		.062 - .437	Dome	.572							
	ABA - 86 - STR	1/4"	.080 - .375	Dome	.560	.525	.117	.157	.261 - .272 (G)	1270	830	100
	ABA - 810 - STR		.350 - .625	Dome	.810							
	ABA - 810E - STR		.080 - .625	Dome	.810							
	ACA - 88 - STR		.160 - .475	C'sunk	.660							
	ABA - 1212 - STR	3/8"	.120 - .560	Dome	.843	.770	.177 MAX	.232	.392 - .408	2950	1900	250
STEEL	SBS - 64 - STR	3/16"	.062 - .270	Dome	.415	.385	.085	.118	.194 - .204 (#10)	1300	1000	150
	SBS - 67 - STR		.214 - .437	Dome	.572							
	SBS - 67E - STR		.062 - .437	Dome	.572							
	SBS - 86 - STR	1/4"	.080 - .375	Dome	.560	.525	.117	.157	.261 - .276 (G)	2400	1850	300
	SBS - 810 - STR		.350 - .625	Dome	.810							
	SBS - 810E - STR		.080 - .625	Dome	.810							
	SCS - 88 - STR		.160 - .475	C'sunk	.660							
	SBS - 1212 - STR	3/8"	.120 - .560	Dome	.843	.770	.177 MAX	.232	.392 - .408	5600	4000	650
STAINLESS	FBF - 64 - STR	3/16"	.062 - .270	Dome	.415	.385	.090	.118	.194 - .204 (#10)	1300	1000	100
	FBF - 67 - STR		.214 - .437	Dome	.572							
	FBF - 67E - STR		.062 - .437	Dome	.572							
	FBF - 86 - STR	1/4"	.080 - .375	Dome	.560	.525	.117	.157	.261 - .276 (G)	2400	1850	200
	FBF - 810 - STR		.350 - .625	Dome	.810							
	FBF - 810E - STR		.080 - .625	Dome	.810							
	FCF - 88 - STR		.160 - .475	C'sunk	.660							



RivetKing® Tigerbolt®

STRUCTURAL BLIND RIVETS • EXTERNAL LOCKING

THE FOLLOWING PRODUCT IS COVERED UNDER THE FOLLOWING PATENT/TRADENAME: 2,386,588

AVAILABLE IN STEEL, ALUMINUM, AND STAINLESS STEEL

* A Special nose piece is required to set externally locked structural blind rivets.

The RivetKing® Tigerbolt® is a structural rivet with an external locking feature. This locking feature is visible after the rivet is applied. When applied, the special nose piece that is required to set the rivet creates a small expansion of a shoulder on the mandrel in a pocket located on the surface of the rivet head. The locking feature can then be inspected and confirmed to be effective during assembly. The Tigerbolt® has a stronger clamp up than the In-lock® and is tighter at minimum grip. The mandrel is retained within the shear plane yielding high strength under shear loads and the external lock insures positive mandrel retention which results in high strength under pullout loads. Typically used in the manufacturing or repair of truck bodies, the Tigerbolt® is leak resistant and has excellent clamp-up force. The Tigerbolt® has a wide grip range and is offered in two diameters and two lengths. The mandrel breaks flush with the head when applied and is set with a special nose piece.

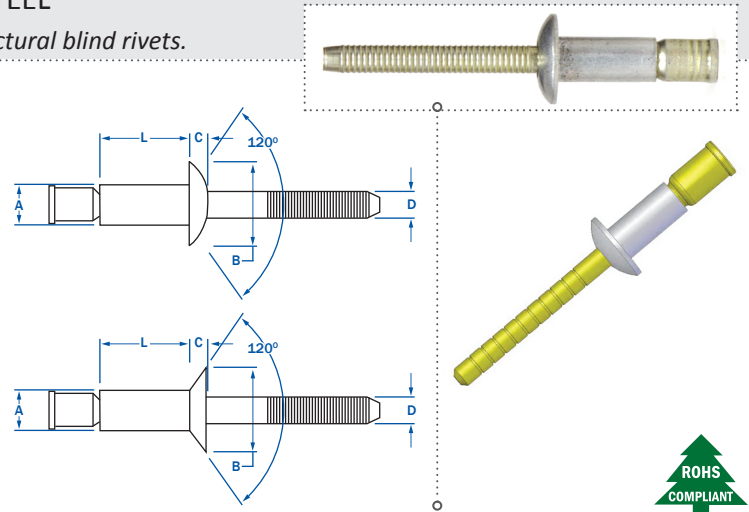

Material	PART NUMBER	A RIVET SIZE	GRIP RANGE MIN. - MAX.	Head Style	L	B	C	D	HOLE SIZE MIN. - MAX.	SHEAR LBS.F	TENSILE LBS.F	MANDREL PUSHOUT LBS.F
					LENGTH MAX	HEAD DIA MAX.	HEAD HEIGHT MAX.	MANDREL DIA NOM.				
ALUMINUM	ABA - 64 - TB	3/16"	.062 - .250	Dome	.416	.400	.090	.118	.194 - .204 (#10)	674	495	50
	ABA - 67 - TB		.062 - .437	Dome	.577							
	ABA - 86 - TB	1/4"	.080 - .375	Dome	.556	.530	.117	.157	.261 - .276 (G)	1349	944	100
	ABA - 810 - TB		.080 - .625	Dome	.806							
	ACA - 88 - TB		.125 - .500	C'sunk	.581							
STEEL	SBS - 64 - TB	3/16"	.062 - .250	Dome	.416	.400	.090	.118	.194 - .204 (#10)	1438	1147	100
	SBS - 67 - TB		.062 - .437	Dome	.577							
	SBS - 86 - TB	1/4"	.080 - .375	Dome	.556	.530	.117	.157	.261 - .276 (G)	2675	2360	250
	SBS - 810 - TB		.080 - .625	Dome	.806							
	SCS - 88 - TB		.125 - .500	C'sunk	.581							
STAINLESS	FBF - 64 - TB	3/16"	.062 - .250	Dome	.416	.400	.090	.118	.194 - .204 (#10)	1438	1146	100
	FBF - 67 - TB		.062 - .437	Dome	.577							
	FBF - 86 - TB	1/4"	.080 - .375	Dome	.556	.530	.117	.157	.261 - .276 (G)	2630	2360	250
	FBF - 810 - TB		.080 - .625	Dome	.806							
	FCF - 88 - TB		.125 - .500	C'sunk	.581							



AVAILABLE MATERIALS: ALL STEEL, ALL ALUMINUM DOME HEAD

The Stemlock® is an advanced structural fastening solution that has among the highest shear and tensile values available because the mandrel is locked into the shear plane. The internal locking mechanism insures positive mandrel retention and will break flush with the head. The Stemlock® is designed to form a bearing surface flange at the rear side of the substrate. This rear flange is perfect for thin sheets or imperfect holes offering impressive clamp up forces without deforming the substrate.

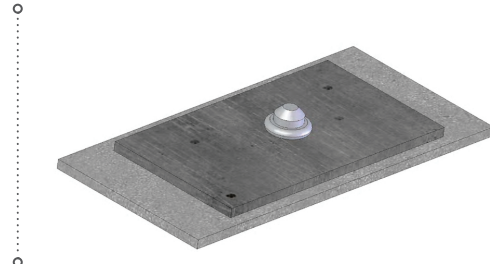
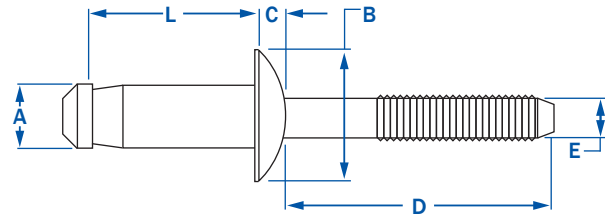

		STANDARD FLANGE								
A			L	A	B	C	E			
RIVET SIZE	PART NUMBER	GRIP RANGE	RIVET LENGTH	BODY	HEAD DIA.	HEAD HEIGHT	MANDREL DIA.	BACKSIDE CLEARANCE	SHEAR STRENGTH	TENSILE STRENGTH
		MIN. - MAX.	MAX	DIA.	MAX.	MAX.	DIA.	MIN.	LBF	LBF
1/4"	STMS-0812	.068 - .138	.539	.250 .260	.530	.110	N/R	.480	2360	1,978
	STMS-0813	.110 - .189	.590						2698	
	STMS-0814	.132 - .211	.612						2810	
	STMS-0815	.189 - .268	.669						3147	
	STMS-0817	.268 - .346	.747						3374	
	STMS-0818	.295 - .374	.775						3597	
	STMS-0819	.346 - .425	.826							
	STMS-0821	.425 - .504	.905							
1/4"	STMA-0812	.068 - .138	.539	.250 .260	.530	.110	N/R	.480	1124	600
	STMA-0813	.110 - .189	.590						1349	
	STMA-0814	.132 - .211	.612						1394	
	STMA-0815	.189 - .268	.669						1460	
	STMA-0817	.268 - .346	.747						1574	
	STMA-0818	.295 - .374	.775							
	STMA-0819	.346 - .425	.826							
	STMA-0821	.425 - .504	.905							

ALUMINUM SUPRATITE - DOME, LOW PROFILE, LARGE FLANGE AND RECESSED CROWN HEADS

Often used in the truck trailer industry, to join very thin sheets of aluminum or steel, where there isn't access on both sides of the application. It is also used to laminate trailer body skin from one side of the trailer.

FEATURES:

- Split Tail formation spreads the tail bearing load on the rear sheet.
- It's ideal for use in thin materials, and has excellent and multigrip range.
- The retained stem provides a very strong, vibration resistant joint.

ASSEMBLY MATERIALS:

Metal to Plastic, Plastic to Plastic, Plastic to Metal, Metal to Metal

TYPICAL APPLICATION:

Domestic Appliances, Plastic Components, Automotive, Trailers, RV, Sporting Goods

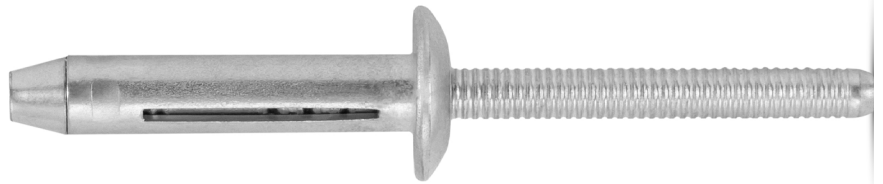

Neoprene or EPDM washer optional and indicated by "W" suffix

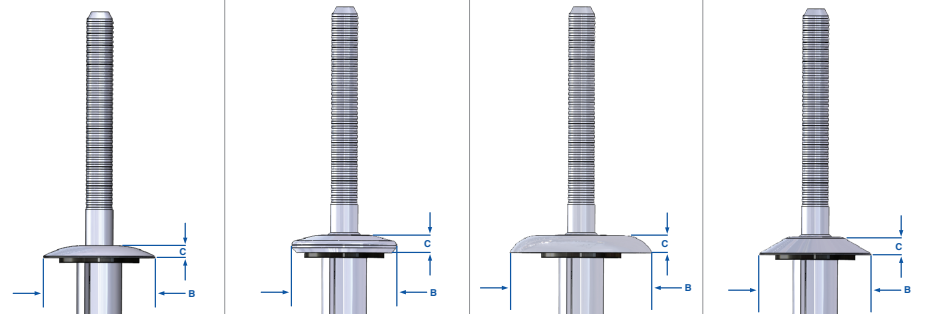

ATT02 LOPRO FLAT HEAD	ATT04/ATT03 DOME HEAD PROTRUDING CROWN	ATT05 LARGE FLANGE PROTRUDING CROWN	ATT06 DOME HEAD RECESSED CROWN
----------------------------------	---	--	---

NOM. SIZE	GRIP CODE	GRIP RANGE	HOLE SIZE	UHL	SHEAR LBS (TYP.)	TENSILE LBS (TYP.)	PART CODE	B		C		PART CODE	B		C		PART CODE	B		C		
								HEAD DIA	HEAD HEIGHT	HEAD DIA	HEAD HEIGHT		HEAD DIA	HEAD HEIGHT	HEAD DIA	HEAD HEIGHT		HEAD DIA	HEAD HEIGHT			
5/32"	5-4	.125 - .250 *.067 - .250	.162/.167 (#20)	.862	160 *350	225	ATT02-5-4	.355 - .375	.057	*ATT04-5-4	.335 - .350	.100										
	5-6	.187 - .375		ATT02-5-6			ATT04-5-6															
	5-8	.250 - .500		ATT02-5-8			ATT04-5-8															
3/16"	6-4	.125 - .250 *.062 - .250	.209/.221 (#4)	.935 *.907	400 *675	450	ATT02-6-4	.430 - .455	.062	*ATT04-6-4	.430 - .455	.125										
	6-6	.187-.375		ATT02-6-6			*ATT04-6-6															
	6-8	.250-.500 *.312-.500		ATT02-6-8			*ATT04-6-8															
	6-10	.375-.625 *.437-.625		ATT02-6-10			*ATT04-6-10															
	6-12	.500-.750 *.563-.750		ATT02-6-12			*ATT04-6-12															
	6-14	.750-.875		ATT02-6-14			ATT04-6-14															
	6-16	.875-1.000		ATT02-6-16			ATT04-6-16															
	6-18	1.000-1.125		ATT02-6-18			ATT04-6-18															
	6-18	1.000-1.125		ATT02-6-18			ATT04-6-18															
1/4"	8-4	.125-.250 *.062/#.040 -.250	.250-.263 (1/4")	1.005	950	575	ATT02-8-4	.532 - .542	.070	*ATT04-8-4	.555 - .565	.150										
	8-6	.187-.375 *.125-.375		ATT02-8-6			*ATT04-8-6															
	8-8	.250-.500		ATT02-8-8			ATT04-8-8															
	8-10	.375-.625		ATT02-8-10			ATT04-8-10															
9/32"	9-3	.032-.187	.304-.3125 (5/16)	1.000	1500	1100				*ATT05-9-3												
	9-6	.032-.375 *.042-.375					*ATT05-9-6															
	9-10	.250-.625		308-.327* (5/16)			*ATT05-9-10															
	9-12	.375-.750					*ATT05-9-12															

ALUMINUM SUPRATITE - COUNTERSUNK AND SHAVEABLE BRAZIER HEADS



The shaveable series is designed for the mandrel to break high, and be cut off with a snipping tool. After snipping, the head can be shaved to match the appearance of solid brazier head rivets commonly used on trailers.

Neoprene or EPDM washer optional and indicated by "W" suffix

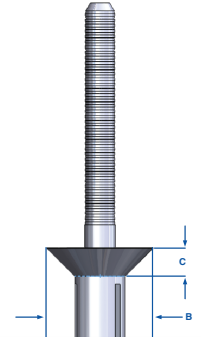
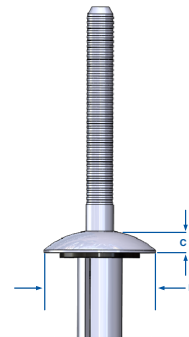

BOLT	GRIP CODE	GRIP RANGE	HOLE SIZE	UHL	SHEAR LBS (TYP.)	TENSILE LBS (TYP.)	ATT07 SHAVE HEAD			ATT01 COUNTERSUNK HEAD		
							PART CODE	B HEAD DIA	C HEAD HEIGHT	PART CODE	B HEAD DIA	C HEAD HEIGHT
5/32"	5-5	.020-.312	.162/.167 (#20)	.920	350	225	ATT07-5-5	.296 - .328	.077			
3/16"	6-3	.020-.187	.209/.221 (#4)	.872	675	450	ATT07-6-3	.446 - .492	.105	ATT01-6-3	.340 min	.108
	6-4	*.050-.250 *.106 - .250		.935			*ATT01-6-4					
	6-6	*.050-.375 *.187 - .375		1.060			*ATT01-6-6					
	6-8	.050 - .500 *.312 - 500		1.185			*ATT01-6-8					
	6-10	*.050 - .625 *.437 - .625		1.310			*ATT01-6-10					
	6-12	*.050 - .750 *.563 - .750		1.435			*ATT01-6-12					
1/4"	8-4	.150-.250	.250-.263 (1/4")	1.005	900 *950	550 *575				ATT01-8-4	.452 min	.164
	8-4	.187-.375		1.310			ATT01-8-6					
	8-6	.250 - .500 *.050 - .500		1.255			*ATT07-8-8	ATT01-8-8				

STEEL SUPRATITE - DOME AND COUNTERSUNK HEADS

Are commonly used in truck trailer when fastening skins to vertical or lateral frames. Steel Supratite can also be used in structural supports for metal buildings or securing panels for AC units, or on uni-strut.

Neoprene or EPDM washer optional and indicated by "W" suffix

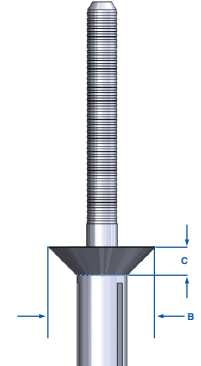
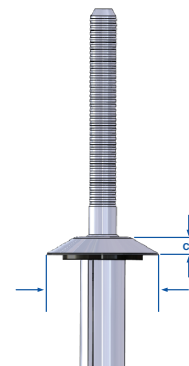

NOM. SIZE	GRIP CODE	GRIP RANGE	HOLE SIZE	UHL	SHEAR LBS (TYP.)	TENSILE LBS (TYP.)	STT76 DOME HEAD			STT71 COUNTERSUNK HEAD		
							PART CODE	B HEAD DIA	C HEAD HEIGHT	PART CODE	B HEAD DIA	C HEAD HEIGHT
1/4"	8-4	.040-.250 *.150-.250	.250-.263 (1/4")	1.005	1250	950	STT76-8-4	.535 - .550	.125	STT71-8-4*	.477 - .485	.165
	8-6	.125-.375 *.187-.375		1.130			STT71-8-6*					
	8-8	.250-.500		1.255 1.355*			STT71-8-8*					
	8-10	.375-.625		1.380			STT76-8-10					



RivetKing® RivBolt™

STEEL/STEEL

THE FOLLOWING PRODUCT IS COVERED UNDER THE FOLLOWING PATENT/TRADEMARK: 3,504,676

The RivetKing® RivBolt™ is ideal for high strength blind precision applications. The RivetKing® RivBolt™ is engineered for the truck/trailer, HVAC, automotive, rail car and structural racking systems. The RivetKing® RivBolt™ has a high shear and tensile value with clamp up for vibration resistance.

Tamper proof easy install from one side of the application with RivetKing® RK-756 or RK-745 tools. The RivetKing® RivBolt™ will break flush in the proper grip range.

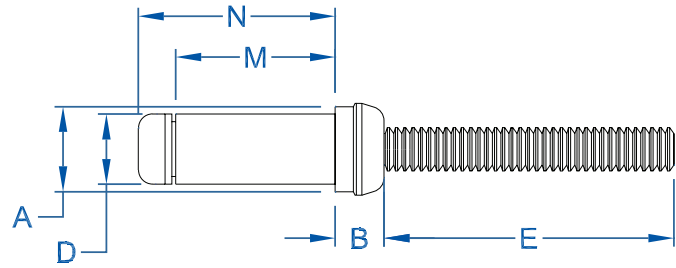

MINIMUM VALUES IN NOMINAL GRIP**

PART NUMBER	DIAMETER	GRIP RANGE	A	B	C	D	E	M	N	SHEAR	TENSILE	HOLE DIAMETER
					MAX.			REF.	MAX.			
RB6-2	3/16"	.093-.156	.276-.286	.152-.168	.015	.196-.206	.785	.376	.500	2800	1800	.208-.222
RB6-3	3/16"	.157-.219	.276-.286	.152-.168	.015	.196-.206	.785	.439	.562	2800	1800	.208-.222
RB6-4	3/16"	.220-.281	.276-.286	.152-.168	.015	.196-.206	.785	.501	.625	2800	1800	.208-.222
RB6-5	3/16"	.282-.344	.276-.286	.152-.168	.015	.196-.206	.785	.564	.687	2800	1800	.208-.222
RB6-6	3/16"	.345-.406	.276-.286	.152-.168	.015	.196-.206	.785	.626	.750	2800	1800	.208-.222
RB6-7	3/16"	.407-.469	.276-.286	.152-.168	.015	.196-.206	.785	.689	.812	2800	1800	.208-.222
RB6-8	3/16"	.470-.531	.276-.286	.152-.168	.015	.196-.206	.785	.751	.875	2800	1800	.208-.222
RB6-9	3/16"	.532-.594	.276-.286	.152-.168	.015	.196-.206	.785	.814	.937	2800	1800	.208-.222
RB6-10	3/16"	.595-.656	.276-.286	.152-.168	.015	.196-.206	.785	.876	1.000	2800	1800	.208-.222
RB6-11	3/16"	.657-.719	.276-.286	.152-.168	.015	.196-.206	.785	.939	1.062	2800	1800	.208-.222
RB6-12	3/16"	.720-.781	.276-.286	.152-.168	.015	.196-.206	.785	1.001	1.125	2800	1800	.208-.222
RB8-2	1/4"	.093-.156	.368-.380	.205-.225	.020	.262-.275	.860	.460	.620	5100	3250	.277-.292
RB8-3	1/4"	.157-.219	.368-.380	.205-.225	.020	.262-.275	.860	.523	.682	5100	3250	.277-.292
RB8-4	1/4"	.220-.281	.368-.380	.205-.225	.020	.262-.275	.860	.585	.745	5100	3250	.277-.292
RB8-5	1/4"	.282-.344	.368-.380	.205-.225	.020	.262-.275	.860	.648	.807	5100	3250	.277-.292
RB8-6	1/4"	.345-.406	.368-.380	.205-.225	.020	.262-.275	.860	.710	.870	5100	3250	.277-.292
RB8-7	1/4"	.407-.469	.368-.380	.205-.225	.020	.262-.275	.860	.773	.932	5100	3250	.277-.292
RB8-8	1/4"	.470-.531	.368-.380	.205-.225	.020	.262-.275	.860	.835	.995	5100	3250	.277-.292
RB8-9	1/4"	.532-.594	.368-.380	.205-.225	.020	.262-.275	.860	.898	1.057	5100	3250	.277-.292
RB8-10	1/4"	.595-.656	.368-.380	.205-.225	.020	.262-.275	.860	.960	1.120	5100	3250	.277-.292
RB8-11	1/4"	.657-.719	.368-.380	.205-.225	.020	.262-.275	.860	1.023	1.182	5100	3250	.277-.292
RB8-12	1/4"	.720-.781	.368-.380	.205-.225	.020	.262-.275	.860	1.085	1.245	5100	3250	.277-.292
RB10-4	5/16"	.188-.312	.468-.478	.266-.278	.025	.332-.346	1.285	.695	.875	8050	5200	.348-.368
RB10-6	5/16"	.313-.437	.468-.478	.266-.278	.025	.332-.346	1.285	.820	1.000	8050	5200	.348-.368
RB10-8	5/16"	.438-.562	.468-.478	.266-.278	.025	.332-.346	1.285	.945	1.125	8050	5200	.348-.368
RB10-10	5/16"	.563-.687	.468-.478	.266-.278	.025	.332-.346	1.285	1.070	1.250	8050	5200	.348-.368
RB10-12	5/16"	.688-.812	.468-.478	.266-.278	.025	.332-.346	1.285	1.195	1.375	8050	5200	.348-.368
RB10-14	5/16"	.813-.937	.468-.478	.266-.278	.025	.332-.346	1.285	1.320	1.500	8050	5200	.348-.368
RB10-16	5/16"	.938-1.062	.468-.478	.266-.278	.025	.332-.346	1.285	1.445	1.625	8050	5200	.348-.368
RB12-4	3/8"	.188-.312	.553-.563	.315-.327	.030	.393-.411	1.230	.766	.969	11100	7250	.413-.435
RB12-6	3/8"	.313-.437	.553-.563	.315-.327	.030	.393-.411	1.230	.891	1.094	11100	7250	.413-.435
RB12-8	3/8"	.438-.562	.553-.563	.315-.327	.030	.393-.411	1.230	1.016	1.219	11100	7250	.413-.435
RB12-10	3/8"	.563-.687	.553-.563	.315-.327	.030	.393-.411	1.230	1.141	1.344	11100	7250	.413-.435
RB12-12	3/8"	.688-.812	.553-.563	.315-.327	.030	.393-.411	1.230	1.266	1.469	11100	7250	.413-.435
RB12-14	3/8"	.813-.937	.553-.563	.315-.327	.030	.393-.411	1.230	1.391	1.594	11100	7250	.413-.435
RB12-16	3/8"	.938-1.062	.553-.563	.315-.327	.030	.393-.411	1.230	1.516	1.719	11100	7250	.413-.435
RB12-18	3/8"	1.063-1.187	.553-.563	.315-.327	.030	.393-.411	1.230	1.641	1.844	11100	7250	.413-.435
RB12-20	3/8"	1.188-1.312	.553-.563	.315-.327	.030	.393-.411	1.230	1.766	1.969	11100	7250	.413-.435

**These are minimum shear and tensile strengths, in pounds, of installed fasteners, when tested in a grip equal to or greater than one and one half the fastener diameter.



RivetKing® Collar Bolt Fixed Grip

COLLAR BOLT

Industrial Rivet's part numbers are made up of six elements which, when correctly designated, completely describe the desired rivet.

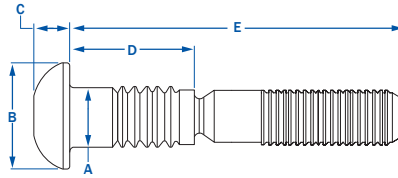

SAMPLE PART NUMBER

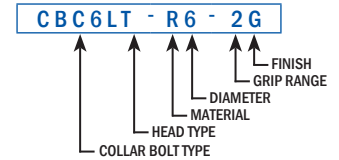

GRIPS

NOM. BODY DIA.	PART NUMBER					GRIP RANGE		NOTCH LENGTH	OVERALL LENGTH	MAX HOLE SIZE
	CATEGORY	HEAD	MATERIAL	DIA-GRIP	PLATING	MIN.	MAX.			
3/16"	CBC6L	T	R	6 - 2	G	0.063	- 0.188	0.394	1.404	0.203
	CBC6L	T	R	6 - 3	G	0.125	- 0.250	0.457	1.466	
	CBC6L	T	R	6 - 4	G	0.188	- 0.313	0.519	1.529	
	CBC6L	T	R	6 - 5	G	0.250	- 0.375	0.582	1.519	
	CBC6L	T	R	6 - 6	G	0.313	- 0.438	0.644	1.654	
	CBC6L	T	R	6 - 7	G	0.375	- 0.500	0.707	1.716	
	CBC6L	T	R	6 - 8	G	0.438	- 0.563	0.769	1.779	
	CBC6L	T	R	6 - 9	G	0.500	- 0.625	0.832	1.841	
	CBC6L	T	R	6 - 10	G	0.563	- 0.688	0.894	1.904	
	CBC6L	T	R	6 - 11	G	0.625	- 0.750	0.957	1.966	
	CBC6L	T	R	6 - 12	G	0.688	- 0.813	1.019	2.029	
	CBC6L	T	R	6 - 13	G	0.750	- 0.875	1.082	2.091	
	CBC6L	T	R	6 - 14	G	0.813	- 0.938	1.144	2.154	
	CBC6L	T	R	6 - 15	G	0.875	- 1.000	1.207	2.216	
	CBC6L	T	R	6 - 16	G	0.938	- 1.063	1.269	2.279	
	CBC6L	T	R	6 - 17	G	1.000	- 1.125	1.332	2.341	
	CBC6L	T	R	6 - 18	G	1.063	- 1.188	1.394	2.404	
	CBC6L	T	R	6 - 19	G	1.125	- 1.250	1.457	2.466	
CBC6L	T	R	6 - 20	G	1.188	- 1.313	1.519	2.529		
1/4"	CBC6L	T	R	8 - 2	G	0.063	- 0.188	0.485	1.520	0.266
	CBC6L	T	R	8 - 3	G	0.125	- 0.250	0.548	1.583	
	CBC6L	T	R	8 - 4	G	0.188	- 0.313	0.610	1.645	
	CBC6L	T	R	8 - 5	G	0.250	- 0.375	0.673	1.708	
	CBC6L	T	R	8 - 6	G	0.313	- 0.438	0.735	1.770	
	CBC6L	T	R	8 - 7	G	0.375	- 0.500	0.798	1.833	
	CBC6L	T	R	8 - 8	G	0.438	- 0.563	0.860	1.895	
	CBC6L	T	R	8 - 9	G	0.500	- 0.625	0.923	1.958	
	CBC6L	T	R	8 - 10	G	0.563	- 0.688	0.985	2.020	
	CBC6L	T	R	8 - 11	G	0.625	- 0.750	1.048	2.083	
	CBC6L	T	R	8 - 12	G	0.688	- 0.813	1.110	2.145	
	CBC6L	T	R	8 - 13	G	0.750	- 0.875	1.173	2.208	
	CBC6L	T	R	8 - 14	G	0.813	- 0.938	1.235	2.270	
	CBC6L	T	R	8 - 15	G	0.875	- 1.000	1.298	2.333	
	CBC6L	T	R	8 - 16	G	0.938	- 1.063	1.360	2.395	
	CBC6L	T	R	8 - 17	G	1.000	- 1.125	1.423	2.458	
	CBC6L	T	R	8 - 18	G	1.063	- 1.188	1.485	2.520	
	CBC6L	T	R	8 - 19	G	1.125	- 1.250	1.548	2.583	
CBC6L	T	R	8 - 20	G	1.188	- 1.313	1.610	2.645		
5/16"	CBC6L	T	R	10 - 4	G	0.125	- 0.375	0.749	1.906	0.328
	CBC6L	T	R	10 - 6	G	0.250	- 0.500	0.874	2.031	
	CBC6L	T	R	10 - 8	G	0.375	- 0.625	1.000	2.156	
	CBC6L	T	R	10 - 10	G	0.500	- 0.750	1.124	2.281	
	CBC6L	T	R	10 - 12	G	0.625	- 0.875	1.249	2.406	
	CBC6L	T	R	10 - 14	G	0.750	- 1.000	1.374	2.531	
	CBC6L	T	R	10 - 16	G	0.875	- 1.125	1.500	2.656	
	CBC6L	T	R	10 - 18	G	1.000	- 1.250	1.624	2.781	
CBC6L	T	R	10 - 20	G	1.125	- 1.375	1.749	2.906		
3/8"	CBC6L	T	R	12 - 4	G	0.125	- 0.375	0.809	2.125	0.391
	CBC6L	T	R	12 - 6	G	0.250	- 0.500	0.934	2.250	
	CBC6L	T	R	12 - 8	G	0.375	- 0.625	1.059	2.375	
	CBC6L	T	R	12 - 10	G	0.500	- 0.750	1.184	2.500	
	CBC6L	T	R	12 - 12	G	0.625	- 0.875	1.309	2.625	
	CBC6L	T	R	12 - 14	G	0.750	- 1.000	1.434	2.750	
	CBC6L	T	R	12 - 16	G	0.875	- 1.125	1.559	2.875	
	CBC6L	T	R	12 - 18	G	1.000	- 1.250	1.684	3.000	
CBC6L	T	R	12 - 20	G	1.125	- 1.375	1.809	3.125		

RK-722 TOOL



RK-745 TOOL



RK-756 TOOL



GRIPS

NOM. BODY DIA.	PART NUMBER				GRIP RANGE		LENGTH	MANDREL DIA.	MAX HOLE SIZE
	CATEGORY	HEAD	MATERIAL	DIA-GRIP	MIN.	MAX.			
3/16"	CBMRP	T	R	6 - 10	0.062	0.625	1.788	.183 - .187	0.203
	CBMGP	T	R	6 - 20	0.312	1.250	2.730		
1/4"	CBMGP	T	R	8 - 10	0.063	0.625	1.965	.245 - .249	0.265
	CBMGP	T	R	8 - 20	0.312	1.250	2.560		
5/16"	CBMGP	T	R	10 - 12	0.125	0.750	2.340	.307 - .311	0.328
	CBMGP	T	R	10 - 22	0.625	1.375	2.840		
3/8"	CBMGP	T	R	12 - 14	0.125	0.875	2.875	.369 - .375	0.390
	CBMGP	T	R	12 - 26	0.812	1.625	3.500		

HEADS

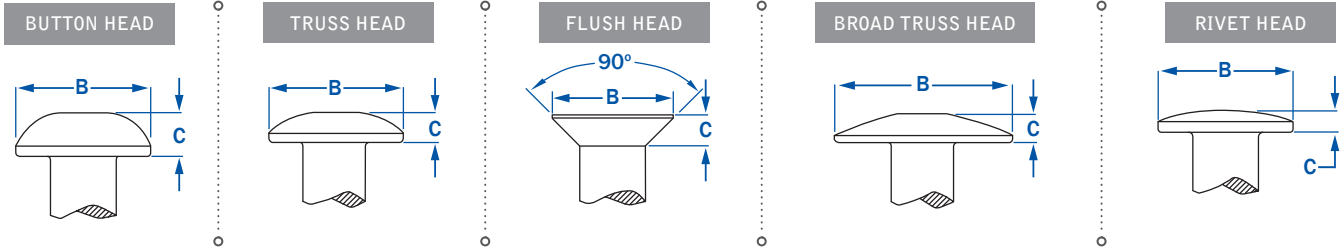

NOM. HEAD DIA.	HEAD DIA.	BUTTON HEAD (B)		TRUSS HEAD (T)		FLUSH HEAD (90)		BROAD TRUSS HEAD (30)		RIVET HEAD (98T)	
		HEAD DIAMETER	HEAD HEIGHT	HEAD DIAMETER	HEAD HEIGHT	HEAD DIAMETER	HEAD HEIGHT	HEAD DIAMETER	HEAD HEIGHT	HEAD DIAMETER	HEAD HEIGHT
3/16"	10	.356 - .394	.113 - .125	N/A	N/A	.323 - .359	.092 - .102	N/A	N/A	.450 - .488	.91 - .105
	20	.356 - .394	.113 - .125	N/A	N/A	.323 - .359	.076 - .087	N/A	N/A	.450 - .488	.91 - .105
1/4"	10	.475 - .525	.136 - .152	.531 - .594	.103 - .115	.433 - .478	.119 - .128	**	.138 - .162	N/A	N/A
	20	.475 - .525	.136 - .152	.531 - .594	.103 - .115	.433 - .478	.102 - .115	**	.138 - .162	N/A	N/A
5/16"	12	.594 - .656	.181 - .201	.703 - .797	.127 - .141	.542 - .594	.149 - .162	N/A	N/A	N/A	N/A
	22	.594 - .656	.181 - .201	.703 - .797	.127 - .141	.542 - .594	.129 - .142	N/A	N/A	N/A	N/A
3/8"	14	.713 - .787	.223 - .248	.828 - .922	.152 - .168	.651 - .714	.178 - .195	1.188 - 1.25	.188 - .212	N/A	N/A
	26	.713 - .787	.223 - .248	.828 - .922	.190 - .200	.651 - .714	.153 - .170	1.188 - 1.25	.188 - .212	N/A	N/A

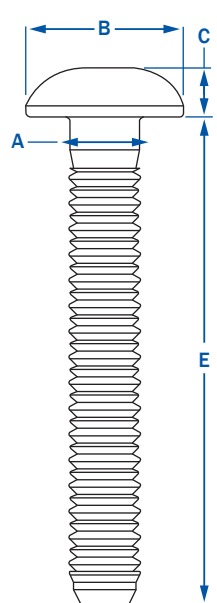

COLLAR DIMENSIONS

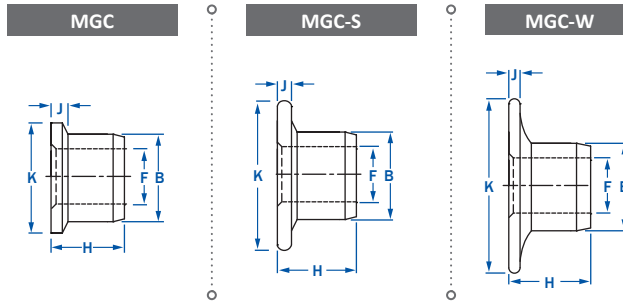

COLLAR	DIAMETER	HOLE DIAMETER (F)	BODY DIAMETER (B)	OVERALL LENGTH (H)	HEAD HEIGHT (J)	FLANGE DIAMETER (K)
MGC	3/16"	.189 - .195	.307 - .313	.265 - .285	.040 - .052	.365 - .385
MGC	1/4"	.250 - .260	.399 - .405	.360 - .390	.055 - .070	.480 - .520
MGC	5/16"	.312 - .320	.501 - .509	.430 - .446	.069 - .086	.605 - .645
MGC	3/8"	.376 - .384	.603 - .611	.490 - .520	.086 - .100	.730 - .770
MGC-S	3/16"	.189 - .195	.308 - .315	.290 - .320	.085 - .115	.495 - .535
MGC-W	3/16"	.189 - .195	.307 - .314	.290 - .320	.090 - .115	.640 - .754
MGC-W	1/4"	.250 - .260	.399 - .405	.432 - .462	.115 - .145	.855 - 1.00

MATERIALS

NOM. BODY DIA.		STEEL (SZ)	ALUMINUM 6061 (A6)
		SHEAR	1725
3/16"	TENSILE	1400	900
	SHEAR	2200	1200
1/4"	TENSILE	2550	1620
	SHEAR	3000	2200
5/16"	TENSILE	3910	2500
	SHEAR	4200	3000
3/8"	TENSILE	5625	4000

HEADS

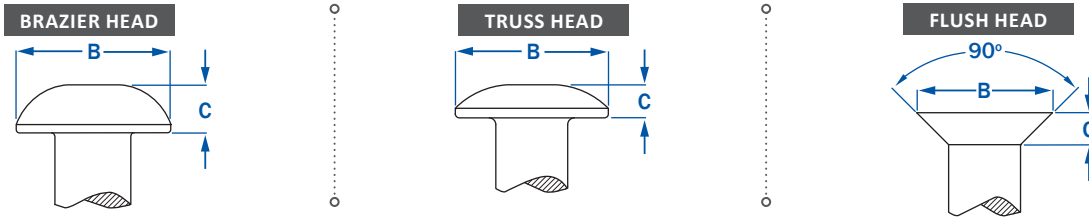

NOM. BODY DIA.	BRAZIER HEAD (B)		TRUSS HEAD (T)		FLUSH HEAD (90)	
	HEAD DIAMETER (B)	HEAD HEIGHT (D)	HEAD DIAMETER (B)	HEAD HEIGHT (D)	HEAD DIAMETER (B)	HEAD HEIGHT (D)
3/16"	.390 - .360	.125 - .113	.469 - .406	.088 - .078	.354 - .328	.085 - .075
1/4"	.525 - .475	.152 - .136	.594 - .531	.115 - .103	.473 - .437	.113 - .101
5/16"	.694 - .556	.201 - .181	.797 - .703	.141 - .127	.589 - .547	.141 - .127
3/8"	.787 - .713	.248 - .223	.922 - .828	.202 - .186	.709 - .656	.168 - .152

Capacity to 1 1/8" Diameter on request

MATERIALS

NOM. BODY DIA.		STEEL (R)	ALUMINUM 2024 (C)	ALUMINUM 6061 (F)	STAINLESS STEEL 18-8 (U)
		3/16"	SHEAR	1725	1050
	TENSILE	1650	1000	530	1455
1/4"	SHEAR	3050	1875	1375	3550
	TENSILE	3000	1800	975	3750
5/16"	SHEAR	4725	2925	2125	5525
	TENSILE	4600	2850	1550	4250
3/8"	SHEAR	6825	4200	3050	7950
	TENSILE	6500	4200	2400	6100

Capacity to 1 1/8" Diameter on request

COLLAR DIMENSIONS

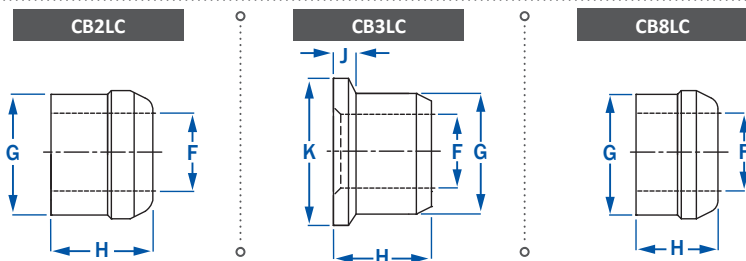

COLLAR	DIAMETER	HOLE DIAMETER (F)	BODY DIAMETER (G)	OVERALL LENGTH (H)	HEAD HEIGHT (J)	HEAD DIAMETER (K)
STANDARD	3/16"	.187 - .196	.311 - .304	.220 - .260		
	1/4"	.256 - .265	.409 - .402	.320 - .290		
	5/16"	.304 - .312	.494 - .485	.380 - .350		
	3/8"	.375 - .385	.600 - .590	.460 - .430		
FLANGE	3/16"	.187 - .196	.311 - .304	.280 - .250	.062 - .031	.391 - .359
	1/4"	.256 - .267	.409 - .402	.379 - .349	.078 - .047	.516 - .484
	5/16"	.304 - .312	.507 - .498	.426 - .394	.094 - .062	.641 - .609
	3/8"	.378 - .390	.610 - .599	.532 - .502	.125 - .062	.781 - .719
LOW PROFILE	3/16"	.187 - .196	.311 - .304	.162 - .132	0.094	
	1/4"	.256 - .265	.409 - .402	.202 - .172	0.125	
	5/16"	.304 - .312	.494 - .485	.255 - .225	0.125	
	3/8"	.375 - .385	.600 - .590	.295 - .310	0.156	

RK-745/KIT • MAX 3/8"



RK-756/KIT • MAX 3/8"



COLLAR BOLT INSTALLATION TOOLS

RK-722 1/4" MAX



RK-745 3/8" MAX



RK-756 3/8" MAX



Collar Bolts & Tools for Collar Bolts larger than 3/8" Diameter are available on request.

COLLAR BOLT INSTALLATION KITS

RivetKing® now offers a complete installation kit for 1/4" thru 3/8" NAS Tension and NAS Shear COLLAR BOLTS and 1/4" thru 5/16" Huck and Cherry Blind Bolts.

The RK745/ RK745/KIT contains:

- Collar Bolts straight noses 1/4", 5/16" & 3/8".
- Blind Bolts straight noses 1/4: & 5/16"

All these items are stored in an easy access carrying case with manuals and data sheets.

RK-745 3/8" MAX



RivetKing® now offers a complete installation kit for 3/16" thru 3/8" MAGNA-GRIP and Maxlok Collar Bolts. The RK756/kit comes with a RK756 installation tool and a set of straight noses.

RK-756 3/8" MAX



COLLAR BOLT™ FIXED GRIP



COLLAR BOLT™ MULTI GRIP



COLLAR

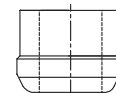



RivetKing® Cross Reference Table for Blind Rivet Selection

BY PART NUMBER • PAGE 1 OF 3

RIVETKING®	POP®	MARSON®	CELUS®	AVDEL®	GESIPA®	CHERRY®
ABA32	AD32ABS	AB3 - 2A	A/A32D		GAMD32A	AAP32
ABS32	AD32BS	AB3 - 2	A/S32D		GSMD32A	BSP - 32
ABA34	AD34ABS	AB3 - 4A	A/A34D		GAMD34A	AAP34
ABS34	AD34BS	AB3 - 4	A/S34D		GSMD34A	BSP - 34
ABA36	AD36ABS					
ABA410	AD410ABS					
ABS410	AD410BS	AB4 - 10	A/S410D		GSMD410A	BSP - 410
ABS41 - 43MGRT	AD41 - 43BS			1691 - 0410		
ABS41 - 43LFMGRT	AD41 - 43BSLF			1692 - 0410		
ABA41	AD41ABS	AB4 - 1A	A/A41D		GAMD41A	AAP41
ABS41	AD41BS	AB4 - 1	A/S41D		GSMD41A	BSP - 41
ABS41CE	AD41H	AB4 - 1CLD			GSMD41AC	
ABA42	AD42ABS	AB4 - 2A	A/A42D		GAMD42A	AAP42
ABA42L	AD42ABSFLF	ABL4 - 2A	A/A42LF		GAML42A	AAL42
ABA42CE	AD42AH		A42AD - CE			
ABS42	AD42BS	AB4 - 2	A/S42D		GSMD42A	BSP - 42
ABS42L	AD42BSFLF	ABL4 - 2	A/S42LF		GSML42A	BSL - 42
ABS42CE	AD42H	AB4 - 2CLD	A42D - CE	SROI - 3265	GSMD42AC	
ABS43 - 45MGRT	AD43 - 45BS			1691 - 0414		
ABS43 - 45LFMGRT	AD43 - 45BSLF			1692 - 0414		
ABA43	AD43ABS	AB4 - 3A	A/A43D		GAMD43A	AAP43
ABA43CE	AD43AH		A43AD - CE			
ABS43	AD43BS	AB4 - 3	A/S43D		GSMD43A	BSP - 43
ABS43LF	AD43BSFLF					
ABS43CE	AD43H	AB4 - 3CLD	A43D - CE	SROI - 3280	GSMD43AC	
ABA44	AD44ABS	AB4 - 4A	A/A44D		GAMD44A	AAP44
ABA44L	AD44ABSFLF	ABL4 - 4A	A/A44LF			AAL44
ABA44CE	AD44AH		A44AD - CE			
ABS44	AD44BS	AB4 - 4	A/S44D		GSMD44A	BSP - 44
ABS44L	AD44BSFLF	ABL4 - 4	A/S44LF		GSML44A	BSL - 44
ABS44CE	AD44H	AB4 - 4CLD	A44D - CE	SROI - 3295	GSMD44AC	
ABS45 - 47MGRT	AD45 - 47BS			1691 - 0416		
ABA45	AD45ABS	AB4 - 5A	A/A45D		GAMD45A	AAP45
ABS45	AD45BS	AB4 - 5	A/S45D		GSMD45A	BSP - 45
ABS45CE	AD45H	AB4 - 5CLD	A45D - CE	SROI - 3211	GSMD45AC	
ABA46	AD46ABS	AB4 - 6A	A/A46D		GAMD46A	AAP46
ABS46	AD46BS	AB4 - 6	A/S46D		GSMD46A	BSP - 46
ABS46CE	AD46H		A46D - CE	SROI - 3212		
ABA48	AD48ABS	AB4 - 8A	A/A48D		GAMD48A	AAP48
ABS48	AD48BS	AB4 - 8	A/S48D		GMSD48A	BSP - 48
ABS48CE	AD48H					
ABS52 - 54MGRT	AD52 - 54BS			1691 - 0512		
ABS52 - 54LFMGRT	AD52 - 54BSLF					
ABA52	AD52ABS	AB5 - 2A	A/A52D		GAMD52A	AAP52
ABS52	AD52BS	AB5 - 2	A/S52D		GSMD52A	BSP - 52
ABS52CE	AD52H	AB5 - 2CLD		SROI - 4080	GSMD52AC	
ABS53 - 55MGRT	AD53 - 55BS			1691 - 0514		
ABS53 - 55LFMGRT	AD53 - 55BSLF			1692 - 0514		
ABA53	AD53ABS	AB5 - 3A	A/A53D		GAMD53A	AAP53
ABS53	AD53BS	AB5 - 3	A/S53D		GSMD53A	BSP - 53
ABS53CE	AD53H	AB5 - 3CLD		SROI - 4095	GSMD53AC	
ABA54	AD54ABS	AB5 - 4A	A/A54D		GAMD54A	AAP54
ABA54L	AD54ABSFLF		A/A54LF			AAL54
ABA54CE	AD54AH		A54AD - CE			
ABS54	AD54BS	AB5 - 4	A/S54A		GSMD54A	BSP - 54
ABS54LF	AD54BSFLF					
				SROI - 4011	GSMD54AC	
ABS54CE	AD55H	AB5 - 5CLD	A54D - CE	SROI - 4012	GSMD55AC	
ABA56	AD56ABS	AB5 - 6A	A/A56D		GAMD56A	AAP56
ABA56LF	AD56ABSFLF					
ABS56	AD56BS	AB5 - 6	A/S56D		GSMD56A	BSP - 56
ABA58	AD58ABS	AB5 - 8A	A/A58D		GAMD58A	AAP58
ABA56L	AD58ABSFLF		A/A56LF			AAL56
ABS58	AD58BS	AB5 - 8	A/S58D		GSMD58A	BSP - 58
ABA610	AD610ABS	AB6 - 10A	A/A610D		GAMD610A	AAP610
ABA610L	AD610ABSFLF	AB6 - 10A	A/A610LF		GAML610A	AAL610
ABS610	AD610BS	AB6 - 10	A/S610D		GSMD610A	BSP610
ABS610L	AD610BSFLF	ABL6 - 10	A/S610LF		GSML610A	BSL610
ABA612	AD612ABS	AB6 - 12A			GAMD612A	AAP612
ABA612L	AD612ABSFLF	AB6 - 12A	A/A612LF		GAML612A	AAL612
ABS612	AD612BS	AB6 - 12	A/S612D		GSMD612A	BSP612
ABS612L	AD612BSFLF	ABL6 - 12	A/S612LF		GSML612A	BSL612
ABS614	AD614BS					
ABS62 - 64MGRT	AD61 - 64SSBS			1663 - 0613		
ABA616	AD616ABS					
ABS616	AD616BS					
ABS616LF	AD616BSFLF					
						BSP - 6 - 156
TABS6203	AD6187TFBS				GSMD63ADP	BSP - 6 - 187
ABS62 - 64MGRT	AD62 - 64BS			1691 - 0613		
ABS62 - 64LFMGRT	AD62 - 64BSLF			1692 - 0613		
ABF62 - 64LFMGRT	AD62 - 64SSBSLF			1643 - 0613		
ABA64/STR	AD6270UG			2774 - 0613	RV6900 - 6 - 4	BAPV - 64
ABA64LF/STR	AD6270UGLF					
ABA62	AD62ABS	AB6 - 2A	A/A62D		GAMD62A	AAP62
ABA62CE	AD62AH		A62AD - CE			
ABS62	AD62BS	AB6 - 2	A/S62D		GSMD62A	BSP62

AVEX® MONOBOLT®, BULBEX®, TRIP®, CHERRYWATE®, MONOBOLT™, INTERLOCK®, HEMLOCK®, STAVEX®, AVINOX® AND AVIBULB® ARE REGISTERED TRADEMARKS OF TEXTRON FASTENING SYSTEMS AND ACCUMINT GLOBAL TECHNOLOGIES INC. ISH® AND ULTRA-Grip® IS A REGISTERED TRADEMARK OF EMMART FASTENING TECHNOLOGIES. TRIP-BULB®, MAGNA-TITE®, AUTO-BULB® AND KIK-LOCK® ARE REGISTERED TRADEMARKS OF ALCOA FASTENING SYSTEMS. CELUSSPLIT™ AND TIGERBOLT® ARE REGISTERED TRADEMARKS OF CELUS FASTENERS.



RivetKing® Cross Reference Table for Blind Rivet Selection

AVEX®, MONOBOLT®, BULBEX®, TLR®, CHERRYMATE, MONOBOLT®, INTERLOCK®, HEMLOCK®, STAVEK®, AVINOK®, AND AVIBULB® ARE REGISTERED TRADEMARKS OF TETRON FASTENING SYSTEMS AND ACCUMUL GLOBAL TECHNOLOGIES INC. LSH® AND ULTRA-GRIP® IS A REGISTERED TRADEMARK OF EMHART FASTENING TECHNOLOGIES. TRI-BULB®, MAGNA-TITE®, AUTO-BULB® AND KLIK-LOCK® ARE REGISTERED TRADEMARKS OF ALCOA FASTENING SYSTEMS. CELUSSPLIT™ AND TIGERBOLT™ ARE REGISTERED TRADEMARKS OF CELUS FASTENERS.

RIVETKING®	POP®	MARSON®	CELUS®	AVDEL®	GESIPA®	CHERRY®
ABS62CE	AD62H	AB6 - 2CLD	A62D - CE	SROI - 4880	GSMD62AC	
ABS63 - 67MGRT	AD63 - 66BS			1691 - 0619		
ABA67S/STR	AD6437UG			2774 - 0617	RV6900 - 6 - 7	BAPV - 67
ABA67SLF/STR	AD6437UGLF					
ABA67LF/STR	AD6437UGLFX					
ABA67/STR	AD6437UGX					
ABS63 - 67MGRT	AD64 - 68SSBSLF			1643 - 0621		
ABA64	AD64ABS	AB6 - 4A	A/A64D		GAMD64A	AAP64
ABA64L	AD64ABSLF		A/A64LF		GAML64A	AAL64
ABA64CE	AD64AH		A64AD - CE			
ABS64	AD64BS	AB6 - 4	A/S64D		GSMD64A	BSP64
ABS64LF	AD64BSLF	ABL6 - 4	A/S64LF		GSML64A	BSL64
				SROI - 4895	GSMD63AC	
ABS64CE	AD64H	AB6 - 4CLD	A64D - CE	SROI - 4811	GSMD64AC	
ABF66CE	AD64SSH					
						BSPT - 6 - 468
TABS6500	AD6519TFBS				GSMD68ADP	BSPT - 6 - 500
ABS66 - 69MGRT	AD66 - 68BS			1691 - 0621		
ABS66 - 69LFMGRT	AD66 - 68BSLF			1692 - 0621		
ABA66	AD66ABS	AB6 - 6A	A/A66D		GAMD66A	AAP66
ABA66L	AD66ABSLF	AB6 - 6A	A/A66LF		GAML66A	AAL66
ABA66CE	AD66AH		A66AD - CE			
ABS66	AD66BS	AB6 - 6	A/S66D		GSMD66A	BSP66
ABS66L	AD66BSLF	ABL6 - 6	A/S66LF		GSML66A	BSL66
					GSMD65AC	
ABS6CE	AD66H	AB6 - 6CLD	A66D - CE	SROI - 4812	GSMD66AC	
ABF66CE	AD66SSH					
ABS610 - 612MGRT*	AD68 - 612BS			1691 - 0631		
ABF610 - 612MGRT*	AD68 - 612SSBSLF			1643 - 0631		
ABA68	AD68ABS	AB6 - 8A	A/A68D		GAMD68A	AAP68
ABA68L	AD68ABSLF	AB6 - 8A	A/A68LF		GAML68A	AAL68
ABA68CE	AD68AH		A68AD - CE			
ABS68	AD68BS	AB6 - 8	A/S68D		GSMD68A	BSP68
ABS68L	AD68BSLF	ABL6 - 8	A/S68LF		GSML68A	BSL68
				SROI - 4814		
ABS68CE	AD68H	AB6 - 8CLD	A68D - CE	SROI - 4816	GSMD68AC	
ABS810	AD810BS		A/S810D		GSMD810A	BSP810
ABA812	AD812ABS	AB8 - 12A	A/A812D		GAMD812A	AAP812
ABS812	AD812BS	AB8 - 12	A/S812D		GSMD812A	BSP812
ABS816	AD816BS					
ABA86/STR	AD8375UG			2774 - 0817	RV6900 - 8 - 6	BAPV - 86
ABA86LF/STR	AD8375UGLF					
ABA84	AD84ABS	AB8 - 4A	A/A84D		GAMD84A	AAP84
ABS84	AD84BS	AB8 - 4	A/S84D		GSMD84A	BSP84
ABS84CE	AD84H	AB8 - 4CLD				
ABA810S/STR	AD8625UG				RV6900 - 8 - 10	BAPV - 810
ABA810SLF/STR	AD8625UGLF					
ABA810LF/STR	AD8625UGLFX					
ABA810/STR	AD8625UGX			2774 - 0824	RV6900 - 8 - 10XC	
ABA86	AD86ABS	AB8 - 6A	A/A86D		GAMD86A	AAP86
ABS86	AD86BS	AB8 - 6	A/S86D		GSMD86A	BSP86
ABS86CE	AD86H	AB8 - 6CLD				
ABS88	AD88BS	AB8 - 8	A/S88D		GSMD88A	
No Equal	ADS46ABS					BSP88
				BF01 - 0516		
ABL - 0516	ADS54ABSL			BF01 - 0523		
ABL - 0523	ADS58ABSL			BF01 - 0523		
				BF01 - 0619		
				BF01 - 0625		
ABL - 0619*	ADS64ABSL			BF01 - 0630		BAPK - 64
				BF01 - 0619		
ABL - 0625*				BF01 - 0625		
ABL - 0630*	ADS66ABS			BF01 - 0630		BAPK - 66
ABS66	ADS66BS					
ACS41 - 44MG/RT	AK41 - 44BS			1682 - 0412		
ACS41CE	AK41H					
ACA42	AK42ABS	AC4 - 2A	A/A42C		GAMC42A	AAC42
ACS42	AK42BS	AC4 - 2	A/S42C		GSMC42A	BSC - 42
ACS42CE	AK42H					
ACS43	AK43BS	AC4 - 3	A/S43C		GSMC43A	BSC - 43
ACS43CE	AK43H					
ACS44	AK44BS	AC4 - 4	A/S44C		GSMC44A	BSC - 44
ACS44CE	AK44H					
ACS45	AK45BS					BSC - 45
ACS45CE	AK45H					
ACS53CE	AK53H					
ACS54	AK54BS					
ACS56	AK56BS					
ACA66/STR	AK6331UG					
ACF64 - 66MG	AK64 - 66SSBS					
ACS64	AK64BS					
ACS64CE	AK64H					
ACS69/STR	AK6500UG					
ACS66CE	AK66H					
ACA88/STR	AK8475UG					
ACA812/STR	AK8725UG					



RivetKing® Cross Reference Table for Blind Rivet Selection

BY PART NUMBER • PAGE 3 OF 3

RIVETKING®	POP®	MARSON®	CELUS®	AVDEL®	GESIPA®	CHERRY®
CBS42	CD42BS	CB4 - 2	C/S42D		GSMD42C	USP42
CBS43CE	CD43H					
CBS44	CD44BS	CB4 - 4	C/S44D		GSMD44C	USP44
SBS32	SD32BS	SB3 - 2	S/S32D		GSMD32S	SSP32
SBS34	SD34BS	SB3 - 4	S/S34D		GSMD34S	SSP34
SBS41	SD41BS	SB4 - 1	S/S41D		GSMD41S	SSP41
SBS42	SD42BS	SB4 - 2	S/S42D		GSMD42S	SSP42
SBS42LF	SD42BSLF	SBL4 - 2	S/S42LF		GSML42S	SSL42
SBS43	SD43BS	SB4 - 3	S/S43D		GSMD43S	SSP43
SBS44	SD44BS	SB4 - 4	S/S44D		GSMD44S	SSP44
SBS44LF	SD44BSLF	SBL4 - 4	S/S44LF		GSML44S	SSL44
SBS45	SD45BS	SB4 - 5	S/S45D		GSMD45S	SSP45
SBS46	SD46BS	SB4 - 6	S/S46D		GSMD46S	SSP46
SBS48	SD48BS	SB4 - 8	S/S48D		GSMD48S	SSP48
SBS52	SD52BS	SB5 - 2	S/S52D		GSMD52S	SSP52
SBS53	SD53BS	SB5 - 3	S/S53D		GSMD53S	SSP53
SBS54	SD54BS	SB5 - 4	S/S54D		GSMD54S	SSP54
SBS54LF	SD54BSLF					
SBS56	SD56BS	SB5 - 6	S/S56D		GSMD56S	SSP56
SBS610	SD610BS	SB6 - 10	S/S610D		GSMD610	SSP610
SBS610LF	SD610BSLF	SBL6 - 10	S/S610LF		GSML610S	SSL610
SBS612	SD612BS	SB6 - 12	S/S612D		GSMD612	SSP612
SBS612LF	SD612BSLF	SBL6 - 12	S/S612LF		GSML612S	SSL612
SBS616	SD616BS					
SBS64/STR	SD6270UG			2771 - 0613	RV6977 - 6 - 4	SSPV - 64
SBS64LF/STR	SD6270UGLF					
SBS62	SD62BS	SB6 - 2	S/S62D		GSMD62S	SSP62
SBS67S/STR	SD6437UG			2771 - 0617	RV6977 - 6 - 7	SSPV - 67
SBS67SLF/STR	SD6437UGLF					
SBS67LF/STR	SD6437UGLFX					
SBS67/STR	SD6437UGX					
SBS64	SD64BS	SB6 - 4	S/S64D		GSMD64S	SSP64
SBS64L	SD64BSLF		S/S64LF		GSML64S	SSL64
SBS66	SD66BS	SB6 - 6	S/S66D		GSMD66S	SSP66
SBS66L	SD66BSLF	SBL6 - 6	S/S66LF		GSML66S	SSL66
SBS68	SD68BS	SB6 - 8	S/S68D		GSMD68S	SSP68
SBS68L	SD68BSLF	SBL6 - 8	S/S68LF		GSML68S	SSL68
SBS810	SD810BS	SB8 - 10	S/S810D		GSMD810S	SSP810
SBS812	SD812BS	SB8 - 12	S/S812D		GSMD812S	SSP812
SBS816	SD816BS					
SBS86/STR	SD8375UG			2771 - 0817	RV6977 - 8 - 6	SSPV - 86
SBS86LF/STR	SD8375UGLF					
SBS84	SD84BS	SB8 - 4	S/S84D		GSMD84S	SSP84
SBS810S/STR	SD8625UG				RV6977 - 8 - 10	SSPV - 810
SBS810SLF/STR	SD8625UGLF					
SBS810/STR	SD8625UGLFX					
SBS810LF/STR	SD8625UGX			2771 - 0824	RV6977 - 8 - 10XG	
SBS86	SD86BS	SB8 - 6	S/S86D		GSMD86S	SSP86
SBS88	SD88BS	SB8 - 8	S/S88D		GSMD88S	SSP88
SCS42	SK42BS	SC4 - 2	S/S42C		GSMD42S	SSC42
SCS44	SK44BS	SC4 - 4	S/S44C		GSMD44S	SSC44
SCS66/STR	SK6331UG					
SCS69/STR	SK6500UG					
SCS88/STR	SK8475UG					
SCS812/STR	SK8725UG					
FBS42	SSD41BS	SSB4 - 1	SS/S41D			CSP41
FBS43	SSD42BS	SSB4 - 2	SS/S42D		GSMD42SS	CSP42
FBS42LF	SSD42BSLF		SS/S42LF			CSL42
FBF42	SSD42SSBS	SSB4 - 2S	SS/SS42D		GSSMD42SS	CCP42
FBF42LF	SSD42SSBSLF					CCL42
FBS44	SSD43BS	SSB4 - 3	SS/S43D		GSMD43SS	CSP43
FBS43LF	SSD43BSLF					
FBF43	SSD43SSBS	SSB4 - 3S	SS/SS43D		GSSMD43SS	CCP43
FBF43LF	SSD43SSBSLF					
FBF43CE	SSD43SSH					
FBS46	SSD44BS	SSB4 - 4	SS/S44D		GSMD44SS	CSP44
FBS44LF	SSD44BSLF					CSL44
FBF44	SSD44SSBS	SSB4 - 4S	SS/SS44D		GSSMD44SS	CCP44
FBF44LF	SSD44SSBSLF					CCL44
FBS48	SSD46BS	SSB4 - 6	SS/S46D		GSMD46SS	CSP46
FBF46	SSD46SSBS	SSB4 - 6S	SS/SS46D		GSSMD46SS	CCP46
FBS48	SSD48BS	SSB4 - 8	SS/S48D		GSMD48SS	CSP48
FBF48	SSD48SSBS	SSB4 - 8S	SS/SS48D		GSSMD48SS	CCP48
FBS52	SSD52BS	SSB5 - 2	SS/S52D		GSMD52SS	CSP52
FBF52	SSD52SSBS	SSB5 - 2S	SS/SS52D		GSSMD52SS	CCP52
FBF53CE	SSD53SSH					
FBS54	SSD54BS	SSB5 - 4	SS/S54D		GSMD54SS	CSP54
FBF54	SSD54SSBS					CCP54
FBS56	SSD56BS	SSB5 - 6	SS/S56D		GSMD56SS	CSP56
FBF56	SSD56SSBS	SSB5 - 6S	SS/SS56D		GSSMD56SS	CCP56
FBF64/STR	SSD6270UG					
FBS62	SSD62BS	SSB6 - 2	SS/S62D		GSMD62SS	CSP62
FBF62	SSD62SSBS	SSB6 - 2S	SS/SS62D		GSSMD62SS	CCP62
FBF62CE	SSD62SSH					
FBS64	SSD64BS	SSB6 - 4	SS/S64D		GSMD64SS	CSP64
FBF64	SSD64SSBS		SS/SS64D			CCP64
FBF64CE	SSD64SSH		SS64SSDCE			
FBS66	SSD66BS	SSB6 - 6	SS/S66D		GSMD66SS	CSP66
FBF66	SSD66SSBS		SS/SS66D			CCP66
FBS68	SSD68BS	SSB6 - 8	SS/S68D		GSMD68SS	CSP68
FBF68	SSD68SSBS		SS/SS68D			CCP68
FBF86/STR	SSD8375UG					
FCF66/STR	SSK6331UG					
FCF88/STR	SSK8475UG					

AVEX® MONOBOLT®, BUREX®, TIR®, CHERRYVALE®, MONOBOLT™, INTERLOCK®, HEMLOCK®, STAVEX®, AVINOX® AND AVIBULB® ARE REGISTERED TRADEMARKS OF TETTRON FASTENING SYSTEMS AND ACCUMENT GLOBAL TECHNOLOGIES INC. LSH® AND ULTRA-Grip® IS A REGISTERED TRADEMARK OF EMHART FASTENING TECHNOLOGIES. TR-BULB®, MAGNA-TITE®, AUTO-BULB® AND KLIK-LOCK® ARE REGISTERED TRADEMARKS OF ALCOA FASTENING SYSTEMS. CELUS® AND TIGERBOLT® ARE REGISTERED TRADEMARKS OF CELUS FASTENERS.

PHONE: 800.289.7483 FAX: 201.750.1050
200 PARIS AVENUE, NORTHVALE, NEW JERSEY 07647 USA



WWW.RIVET.COM