

RIVETKING® IKS SERIES™ - ROUND KNURLED BODY, LOW PROFILE HEAD, THIN WALL RIVET STUD

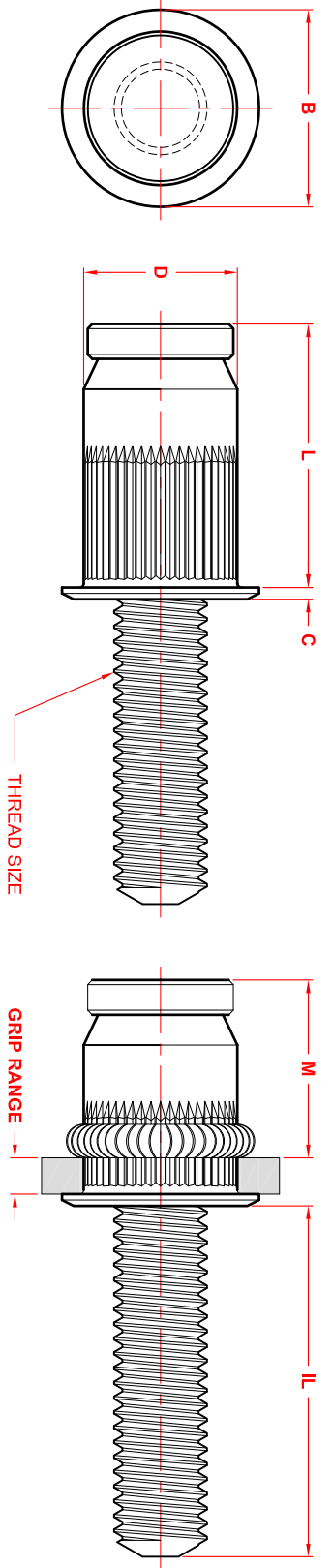

PART NUMBER EXAMPLE = 25C1KSSV / .625 (PART CODE + MATERIAL + FINISH / STUD LENGTH)

THREAD SIZE	PART CODE	GRIP RANGE	L		B	C	D	M	IL		HOLE SIZE IN SHEET	
			MIN - MAX	±.020					HEAD DIA	HEAD HEIGHT		BLIND HEIGHT
#6-32	6C21KS	.020 - .080	.485	±.020	.390	.030	.265	.360	.500	.625	.750	.266
#6-32	6C21KS	.080 - .130	.535	±.020	.390	.030	.265	.360	.450	.575	.700	.266
#8-32	8C21KS	.020 - .080	.485	±.020	.390	.030	.265	.360	.500	.625	.750	.266
#8-32	8C21KS	.080 - .130	.535	±.020	.390	.030	.265	.360	.450	.575	.700	.266
#10-32	10F21KS	.020 - .130	.545	±.020	.415	.030	.296	.380	.500	.625	.750	.297
#10-32	10F21KS	.130 - .225	.655	±.020	.415	.030	.296	.380	.405	.530	.655	.297
1/4-20	25C21KS	.027 - .165	.670	±.020	.500	.030	.390	.465	.625	.813	1.000	.391
1/4-20	25C21KS	.165 - .260	.770	±.020	.500	.030	.390	.465	.530	.718	.905	.391
5/16-18	31C21KS	.027 - .150	.810	±.020	.685*	.035	.530	.600	.625	.875	1.125	.531
5/16-18	31C21KS	.150 - .312	.925	±.020	.685*	.035	.530	.555	.463	.713	.963	.531
3/8-16	37C21KS	.027 - .150	.810	±.020	.685*	.035	.530	.600	.750	1.000	1.250	.531
3/8-16	37C21KS	.150 - .312	.925	±.020	.685*	.035	.530	.535	.588	.838	1.088	.531

METRIC DIMENSIONS - RIVET NUT SPECIFICATIONS

THREAD SIZE	PART CODE	GRIP RANGE	L		B	C	D	M	IL		HOLE SIZE IN SHEET	
			MIN - MAX	±0.50					HEAD DIA	HEAD HEIGHT		BLIND HEIGHT
M4x0.7	.40C1IKS	0.5 - 2.0	12.32	±0.50	9.91	0.76	6.73	9.15	12.0	15.0	20.0	6.75
M4x0.7	.40C2IKS	2.0 - 3.3	13.59	±0.50	9.91	0.76	6.73	9.15	10.7	13.7	18.7	6.75
M5x0.8	.50C1IKS	0.5 - 3.3	13.84	±0.50	10.54	0.76	7.52	9.65	12.0	15.0	20.0	7.60
M5x0.8	.50C2IKS	3.3 - 5.7	16.64	±0.50	10.54	0.76	7.52	9.65	9.6	12.6	17.6	7.60
M6x1.0	.60C1IKS	0.7 - 4.2	17.02	±0.50	12.70	0.76	9.91	11.81	15.0	20.0	25.0	10.00
M6x1.0	.60C2IKS	4.2 - 6.6	19.56	±0.50	12.70	0.76	9.91	11.81	12.6	17.6	22.6	10.00
M8x1.25	.80C1IKS	0.7 - 3.8	20.57	±0.50	17.40*	0.89	13.46	16.0	15.24	22.0	28.0	13.50
M8x1.25	.80C2IKS	3.8 - 7.9	23.50	±0.50	17.40*	0.89	13.46	14.10	11.9	17.9	23.9	13.50
M10x1.50	.100C1IKS	0.7 - 3.8	20.57	±0.50	17.40*	0.89	13.46	15.24	20.0	25.0	30.0	13.50
M10x1.50	.100C2IKS	3.8 - 7.9	23.50	±0.50	17.40*	0.89	13.46	13.60	15.9	20.9	25.9	13.50

COMPATIBILITY - THIS DRAWING AND THE INFORMATION IT CONTAINS ARE THE SOLE PROPERTY OF INDUSTRIAL RIVET & FASTENER CO. THIS DRAWING IS USED AS A SELLING AND/OR MANUFACTURING DEVICE WHICH MAY CONTAIN INFORMATION THAT IS PATENTED OR TRADEMARKED BY THE INDUSTRIAL RIVET & FASTENER CO. REPRODUCTION OR DISCUSSURE BY ANYONE, OF ANY PART OF THIS DRAWING OR INFORMATION THEREON OR THE USE THEREOF FOR ANY OTHER PURPOSES WITHOUT THE WRITTEN CONSENT OF INDUSTRIAL RIVET & FASTENER CO. IS STRICTLY PROHIBITED.

CONTINUOUS IMPROVEMENT - INDUSTRIAL RIVET AND FASTENER CO. HAS CONTINUOUS IMPROVEMENT POLICIES/PROCEDURES IN PLACE AND THEREFORE RESERVES THE RIGHT TO CORRECT, CHANGE OR IMPROVE PRODUCTS AND/OR SPECIFICATIONS WITHOUT NOTICE, UNLESS DESIGNATED BY AN S-XXXXX NUMBER. DIMENSIONS IN INCHES UNLESS OTHERWISE STATED. DIMENSIONS IN PARENTHESIS ARE FOR REFERENCE ONLY. REMOVE ALL BURRS & SHARP EDGES.

REV	DESCRIPTION	DATE
E	Dwg revised/updated, and corrections made	6.09.26
D	Correction: M5 Grip Ranges C1 was 0.5-2.0; C2 was 2.0-3.3	2.26.26
C	Thread Correction: M10x1.50 was M10x1.75	7.11.25
B	'IL' was NOM	5.06.25
A	Dwg Desc revised, Cad finish nomenclature revised, Matl was L/C Steel, Dim nomenclature revised	4.18.25
-	Drawing Released	8.14.24

MATERIAL & FINISH SPEC'S
MATL: RIVET NUT: S = STEEL, LOW CARBON 6%-10% THREADED STUD: CARBON STEEL
HEAT TREAT: RIVET NUT - S/R THREADED STUD - HEAT TREATED
SURF FINISH: Y = ZINC YELLOW ROHS Z = ZINC CLEAR ROHS C = CAD YELLOW PLATED ZN = ZINC NICKEL

ALTERNATIVE FINISHES ARE INDICATED BY THE SUFFIX IN THE PART NUMBER AND ARE REFERENCED ON ORDER DOCUMENTS

PROCESSING: MTL RCPT COLD FORM S/R FINISH TAPPING FINISH ASSTY FQC PACK

REDRAWN: REIMnl6.08.26 APPROVED: RE/6.09.26 APPROVED: RK/6.09.26 APPROVED: (rev,d1) xx/xx.xx.xx

DESCRIPTION: **ROUND KNURLED BODY, LOW PROFILE HEAD, THIN WALL RIVET STUD**

LIMITS UNLESS STATED: DECIMAL ±.015 ANGULAR ±2° SURFACE TEXTURE

INDUSTRIAL Rivet & Fastener Co. 35 MAPLE STREET NORWOOD, NJ, 07648 TEL: (201) 750 1040 info@rivet.com

SHEET: 1 OF 1 SALES PART# AS NOTED ON CHART REV: E DWG# IKS SERIES